



A.D.L.E.R Glaserei GmbH

Website : www.adler-glaserei.com

FIDICINTRABE 3 10965 BERLIN, GERMANY

Agent in middle east & Africa, Advance Building Technologies Co. LTD.

Tel : +971 6 534 6246 , Fax : +971 6 534 6757 , P.O.BOX 81617

Web : WWW.ADCO.SA , E-mail : SHARJAH@ADCO.SA

Adler

Aluminum & Accessories

Hinge door handle

C-AD 101

Double handle with die-cast aluminium shaft,
It has an easy moving cover screws case, planned for the ambidextrous rotation
without any modification,
Different
solutions available for the assembling: with auto
threading screws or with the use of metrical
screws and rivets.
The double internal recovery spring
assures a perfect horizontal alignment.
Die-cast aluminium handle, box,
cover box and rotor in zamak.
Zinc-coated steel spring;
derlin anti-friction bushes.

Finishing : painted in RAL colors

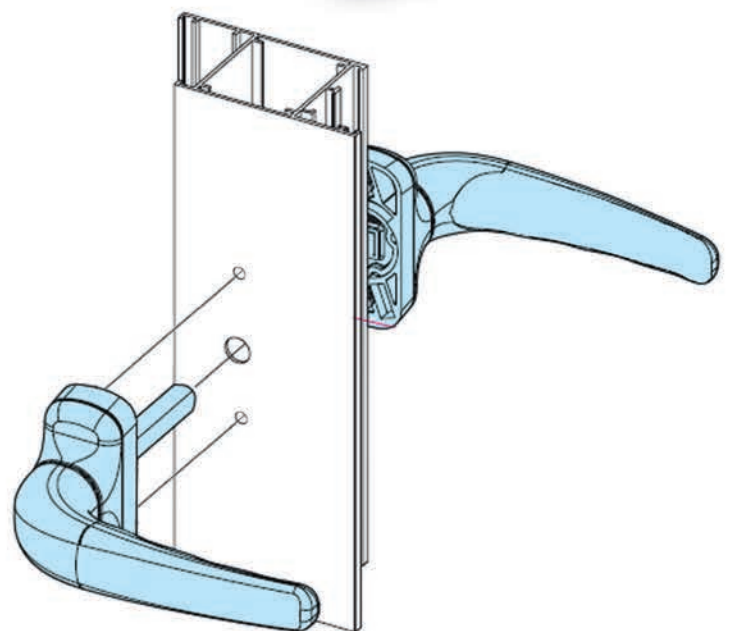
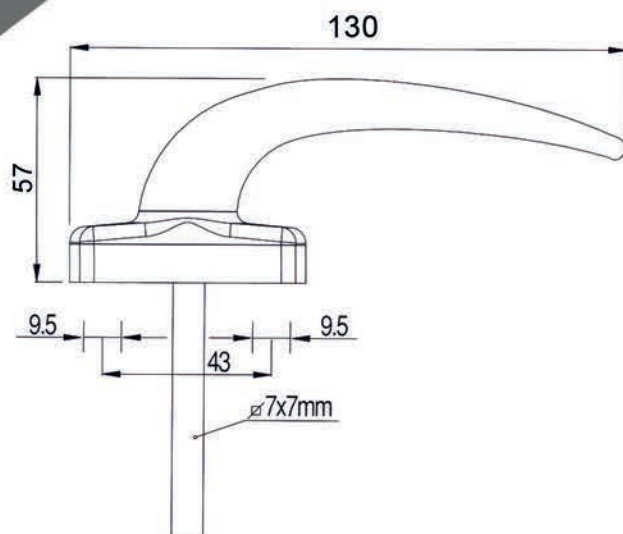

C-AD 102

Hinge door handle

Double Door handle with die-cast aluminium shaft, available with comfort designs. It has an easy moving cover screws case, planned for the ambidextrous rotation without any modification, Different solutions available for the assembling: with auto threading screws, with the use of metrical screws and rivets or with the use of anti housebreaking kits. The double internal recovery spring assures a perfect horizontal alignment. Die-cast aluminium handle, box, cover box and rotor in zamak. Zinc-coated steel, derlin anti-friction bushes.

Finishing : painted in RAL colors

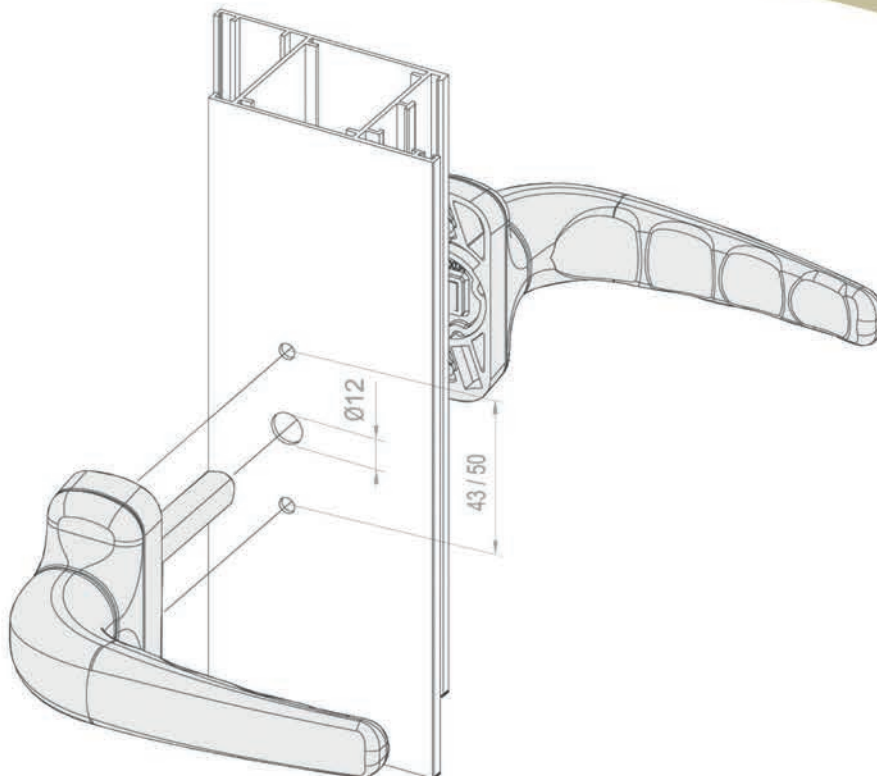
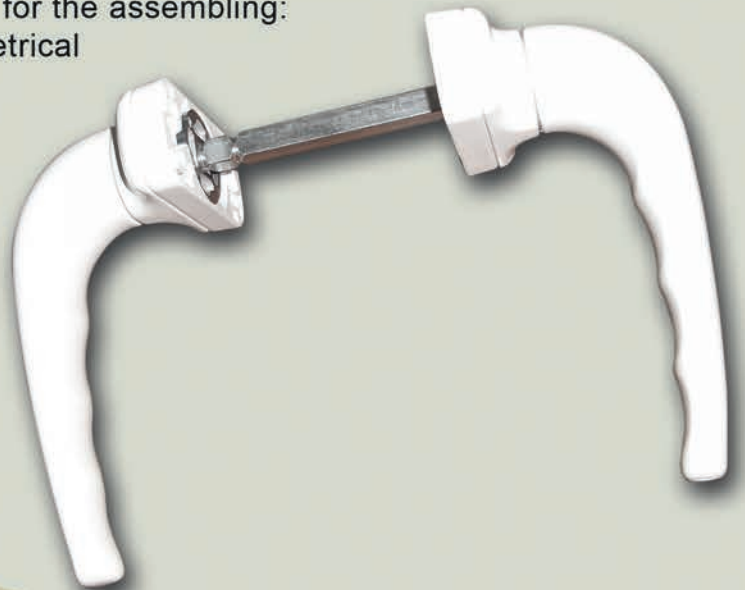

C-AD 103

Two wings (Flash base hinge)

Tow -wing hinge made from aluminum , extrusion
to fit in euro groove profiles
the coun-terplates, screws and pin are stainless steel
while the bush is made from self-lubricating nylon .
it is ready -assembled right or
lift and so easy to fit to the wing.
Capacity of 2 hinges , 80kg

Finishing : painted in RAL colors

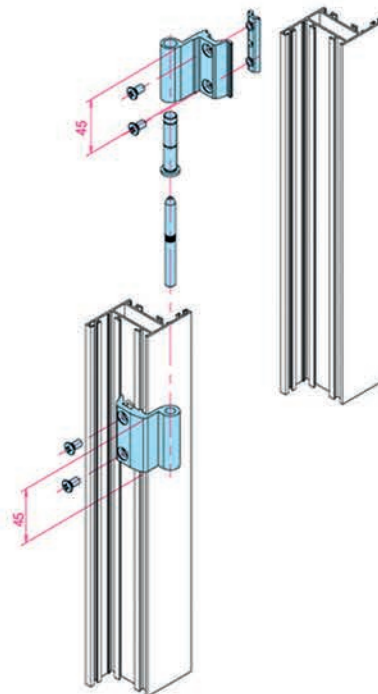
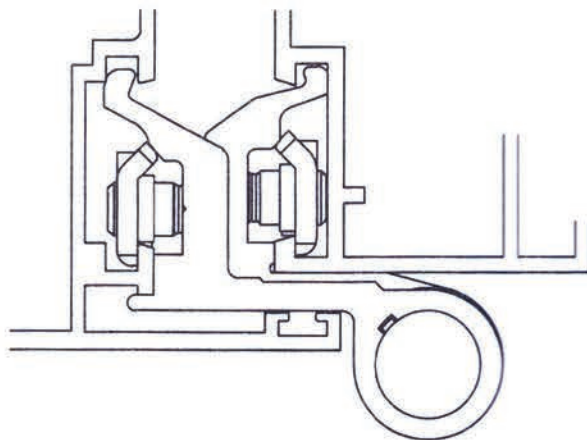

C-AD 104

Three wings (Flash base hinge)



three –wing hinge made from aluminum ,
the counterpales,
screws and pin are stainless steel
while the bush is made from
self-lubricating nylon .
it is ready –assembled right or lift
and so easy to fit to the wing.
Capacity of 2 hinges , 90kg

Finishing : painted in RAL colors

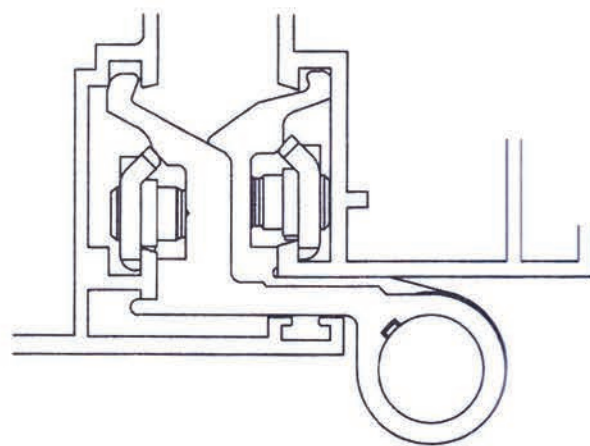
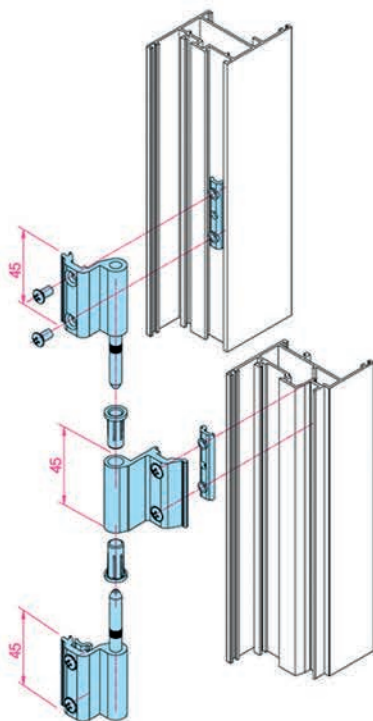

Bridge hinge

C-AD 105

Group of right and left handed Bridge hinge made of extruded aluminum projects , screws and pin are stainless steel . Used for joint frame with opening shutter of door.
Capacity of 2 hinges 100kg

Finishing : painted in RAL colors

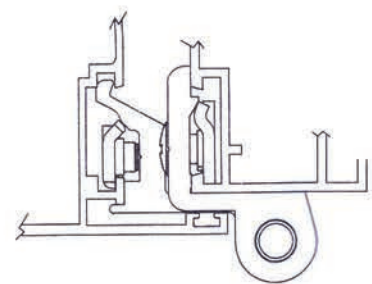
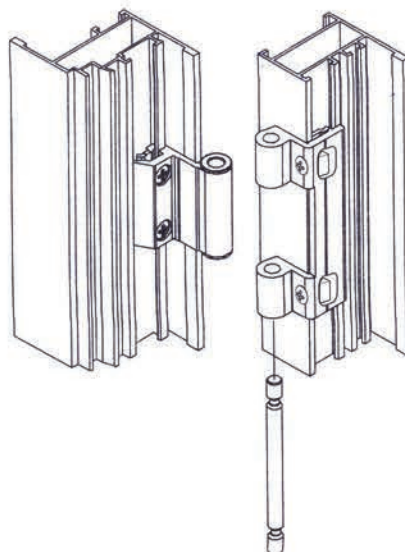
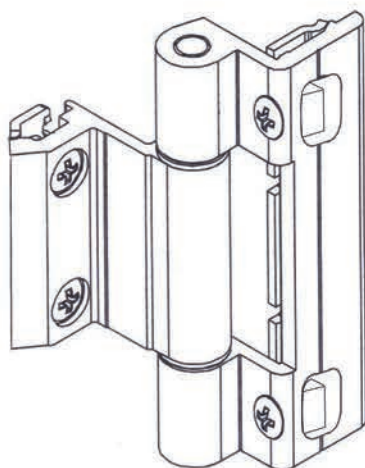

Profile Hinges

Profile hinges
 Hingh tensil aluminum alloy .
 Steel loose pin with nylon end caps
 And double nylon washers .
 Lift-off and Bi-folding .
 Reversible for left and right hand use .
 Available in 40mm & 60mm hinge leafs length
 Finishing : painted in RAL color.

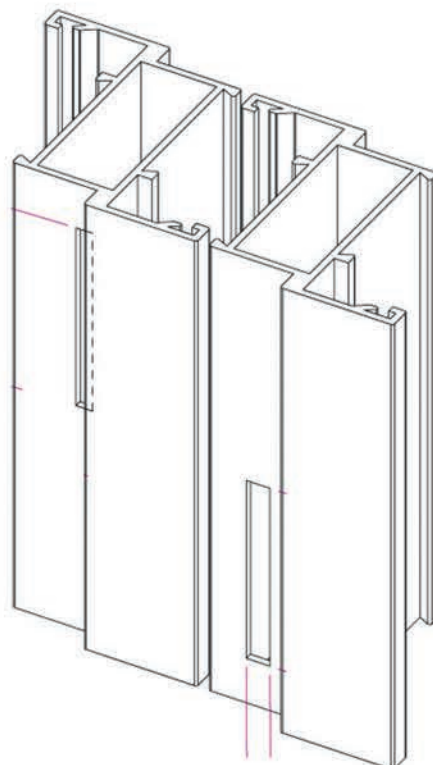
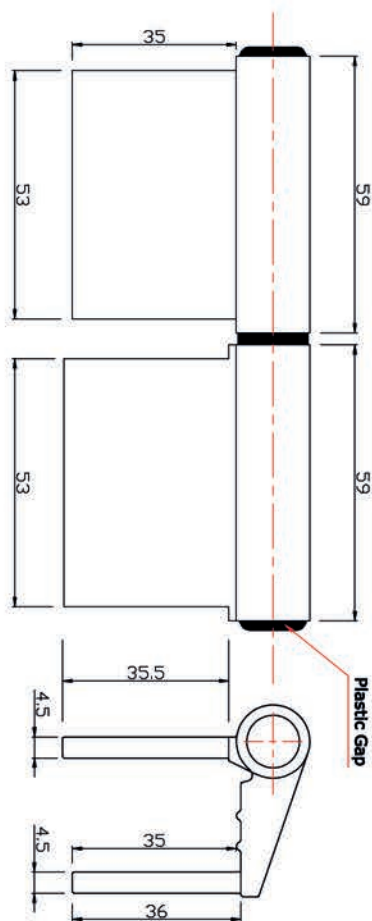

HEAVY DUTY HINGES

The heavy duty hinge is the most efficacious solution for the realisation of doors/frames of considerable dimension and weight. It can be entirely mounted on the pre-assembled frame, thanks to the fast adjustments in the three directions, made without the disassembling of the carter and the removing of the window leaf. This operation can be effected also by one person and is facilitated by the presence of immediately visible incisions.

Hinges are available for different interaxes: 60-79

The base body of the hinge is made of extruded aluminium, cover-plate in die-casting aluminium, pivots in stainless steel, self-placing bushes and screws in galvanised steel, ferrules and plugs in nylon, fixing counterplates in extruded aluminium and the spring in galvanised steel.

Load capacity of 2 wings - 150kg .

Finishing : painted in RAL colors



interasse	A	B
60	20,5	39,5
79	39,5	39,5

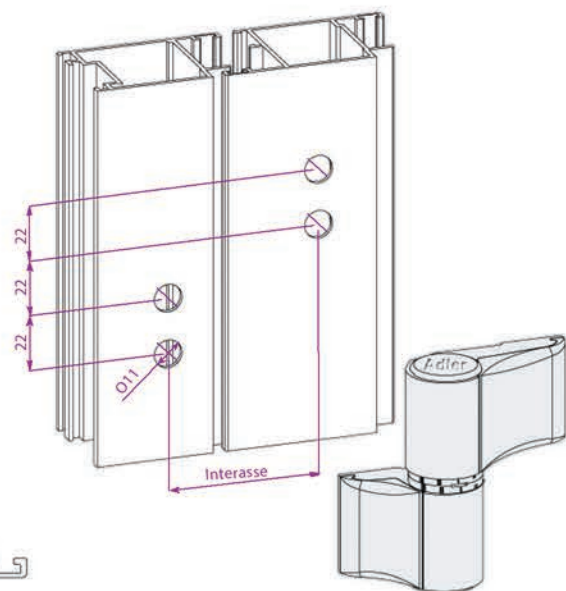
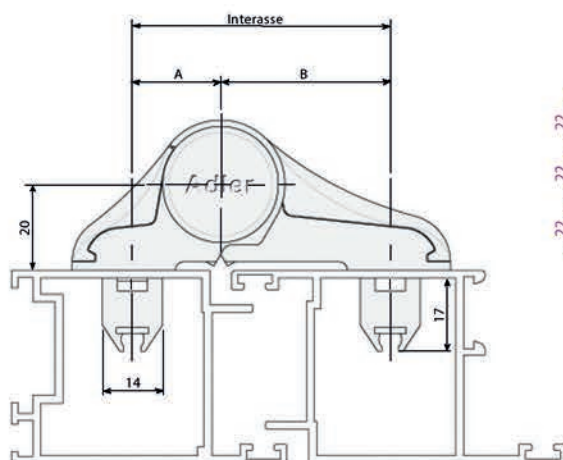

cremone bolt handle

Aluminum die-cast cremone bolt, the zamak gears slide inside an acetyl resin guide, which also has slots for securing in the opening or closing positions. The cremone bolt is universal, can be reversed and has two possible center-to-center distances for securing to the profile. Comes with complete kit for the closing one winged window, consisting of two rod connection blocks for cremone bolt, two rod ends and two check plates, made from zamak.

Finishing : painted in RAL colors

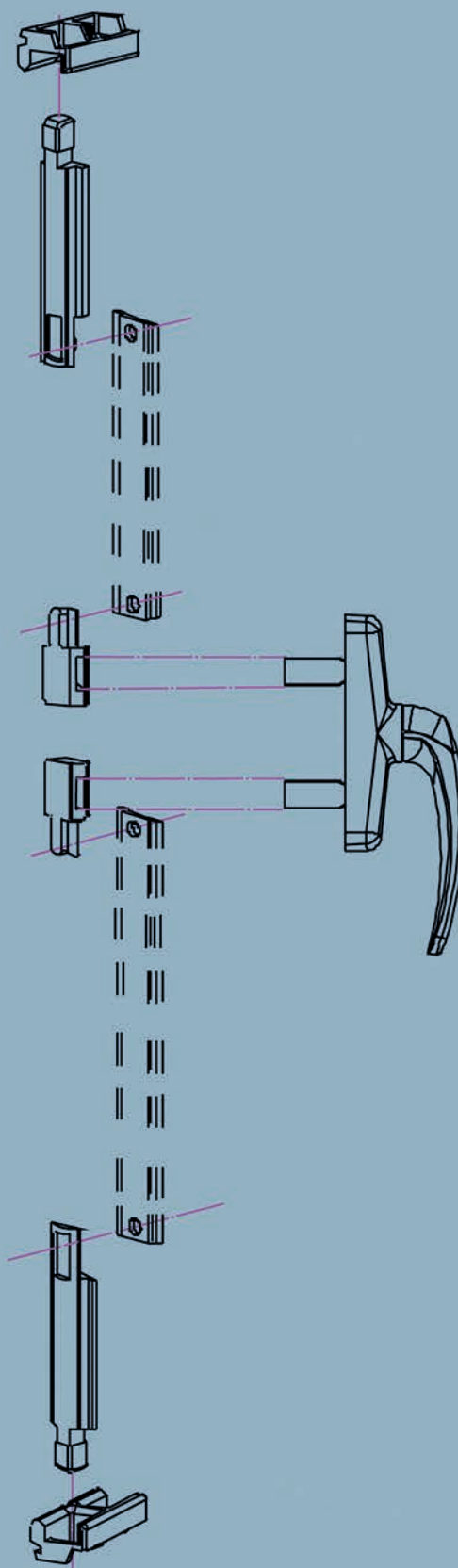
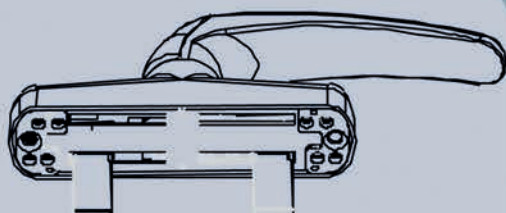
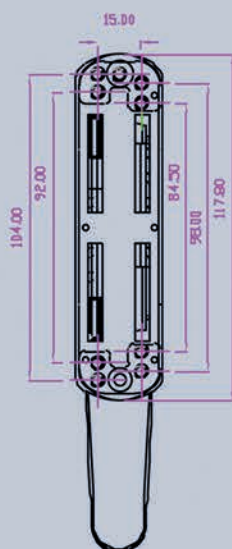
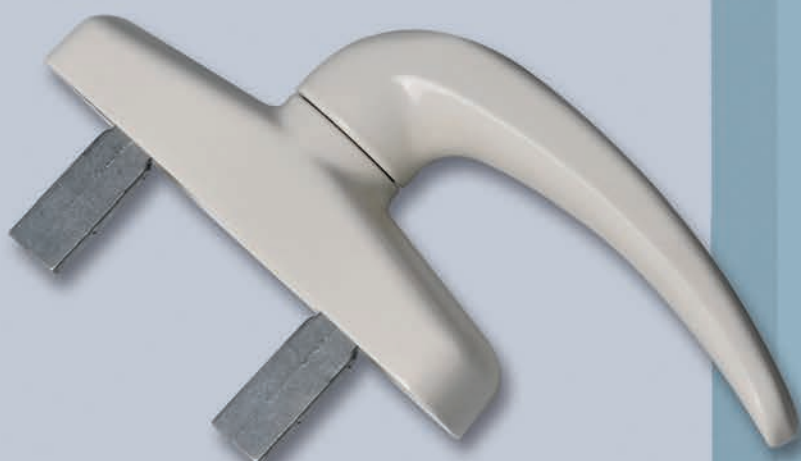

C-AD 109

Cremone bolt handle

die-cast aluminum cremone bolt with zamak gears slide inside an acetyl resin guide, which also has slots for securing in the opening and closing positions, the cremone bolt is universal ,can be reversed and has two possible center -to- center

Finishing : painted in RAL colors

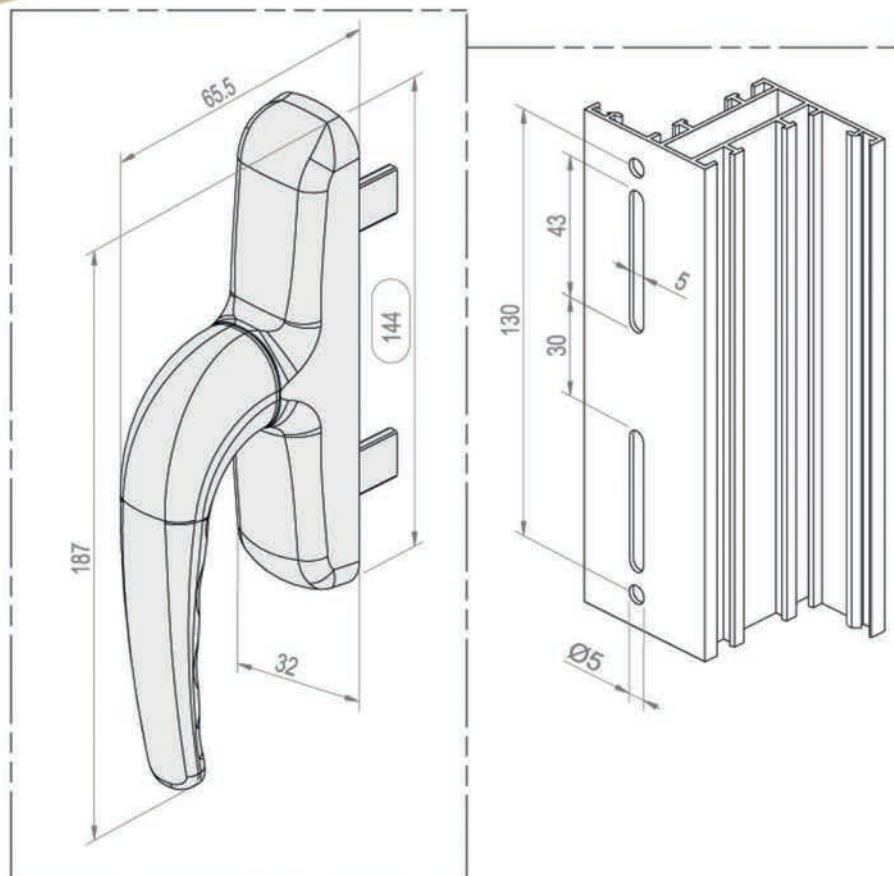

C-AD 110

LOCKING KIT

Kit for use in conjunction with window Cremone bolts and the kit has all the components needed for the frame fastening device.

This kit converts the window Cremone bolts into a Cremone bolt for inward opening designs. The kit is complete with all the components (2 blocks, 2 end-pieces and 2 keeps) needed for the frame fastening device.

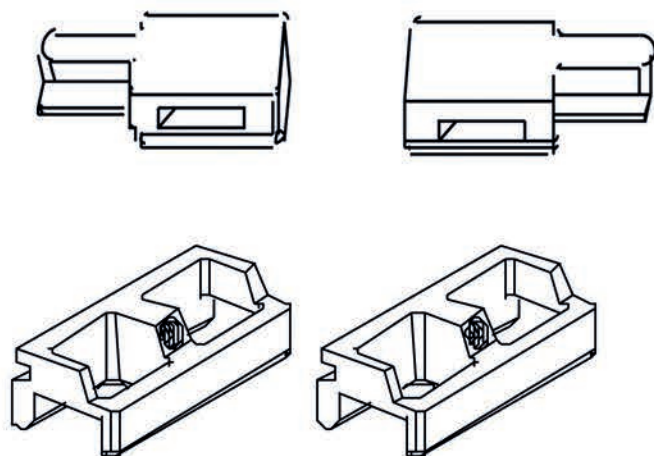
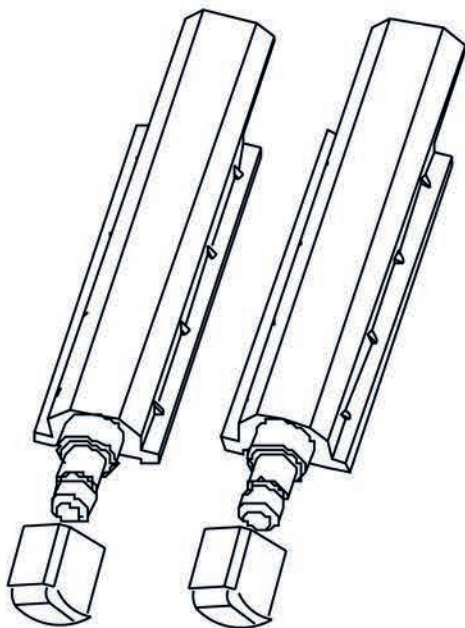
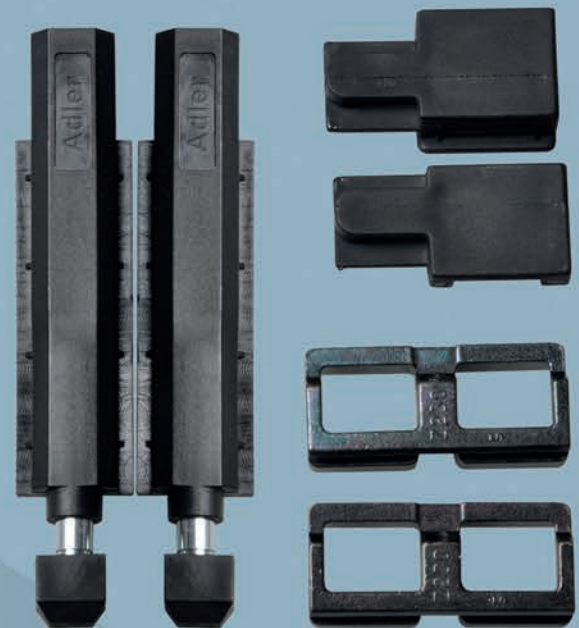

Lever window handle

C-AD 111

Reversible lever handle fittable for internal/external, left/ right installation to close top-hung and pivot – hung window, and hand reversal possible by swapping over the handle

Finishes: painted in RAL colors.

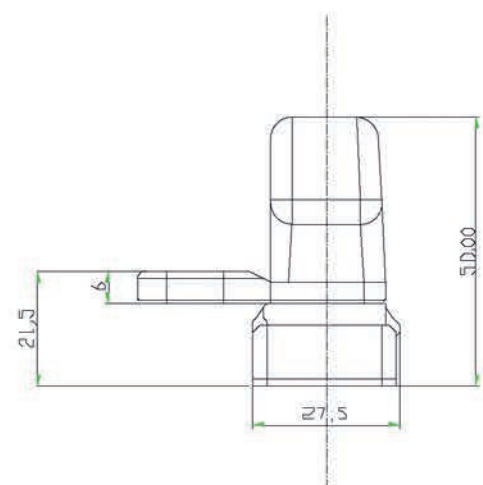
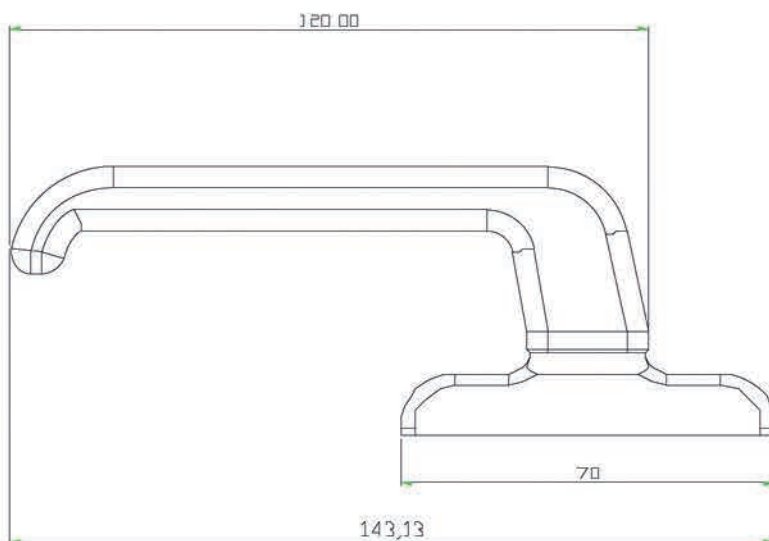
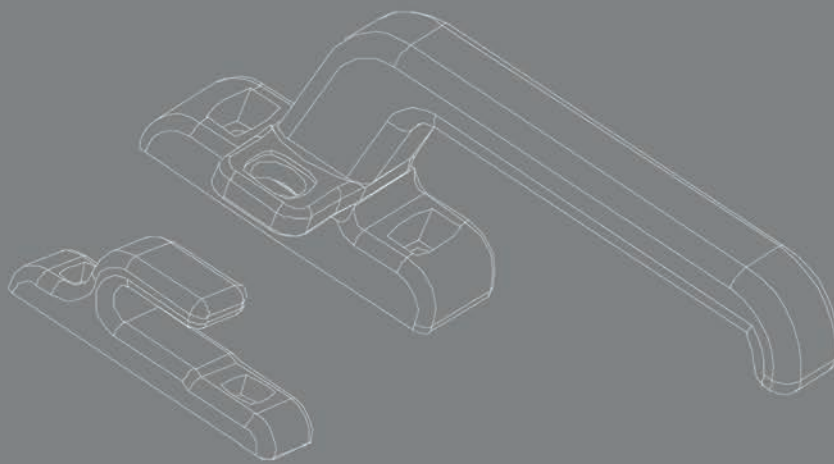

curve curtain wall handle

The employ of Die-cast aluminum handle and zamak case . its differs from the basic casement bolt because, apart from having only one transmission fin, it has an offset handle for ease of grip since it is to be applied on the lower strut of outward opining windows.

Finishing : painted in RAL colors

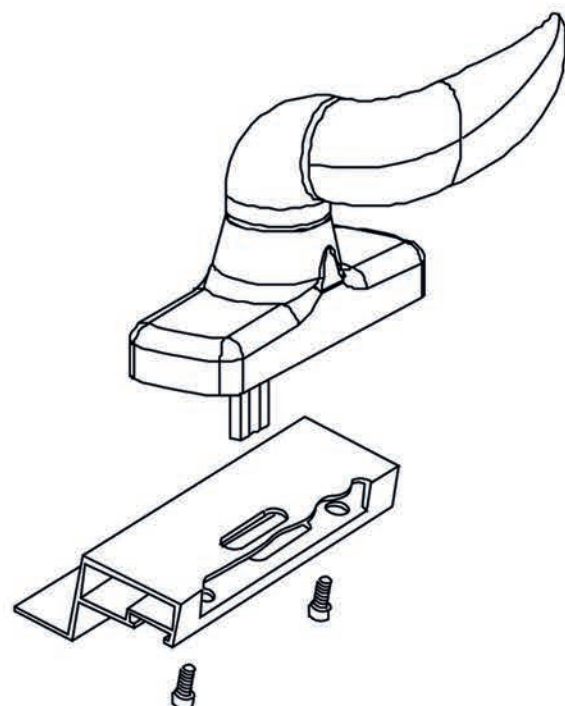
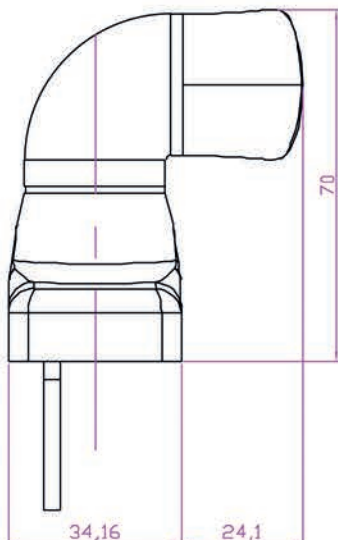

OUTWARD TOP-HUNG OPENING SYSTEM

Accessory which can be fitted on the rods of the cremone bolts to have an additional lock.
Galvanized steel pivot and screw M5.
zamak closing eccentric; adjustable in 8 different positions and adaptable with the counterplates

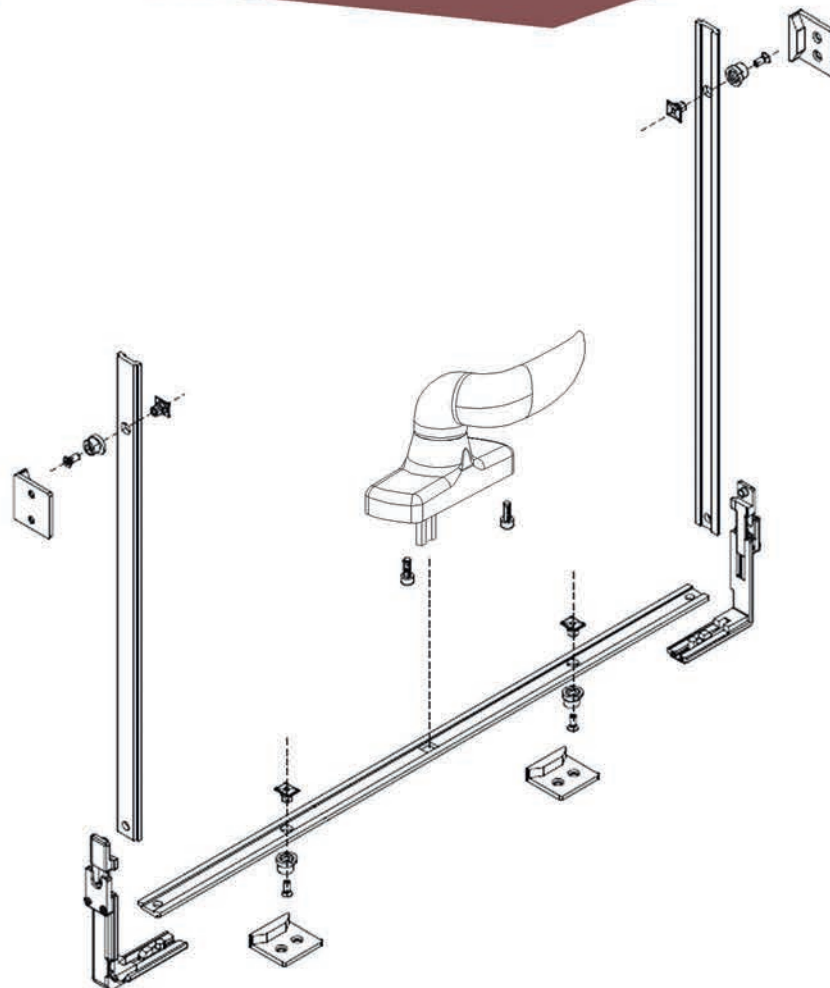

ADDITIONAL VERTICAL LOCK

It allows the application of two additional vertical closing points, one on the cremone bolt side and the other one on the hinge side. Materials made from black galvanized Zamak.

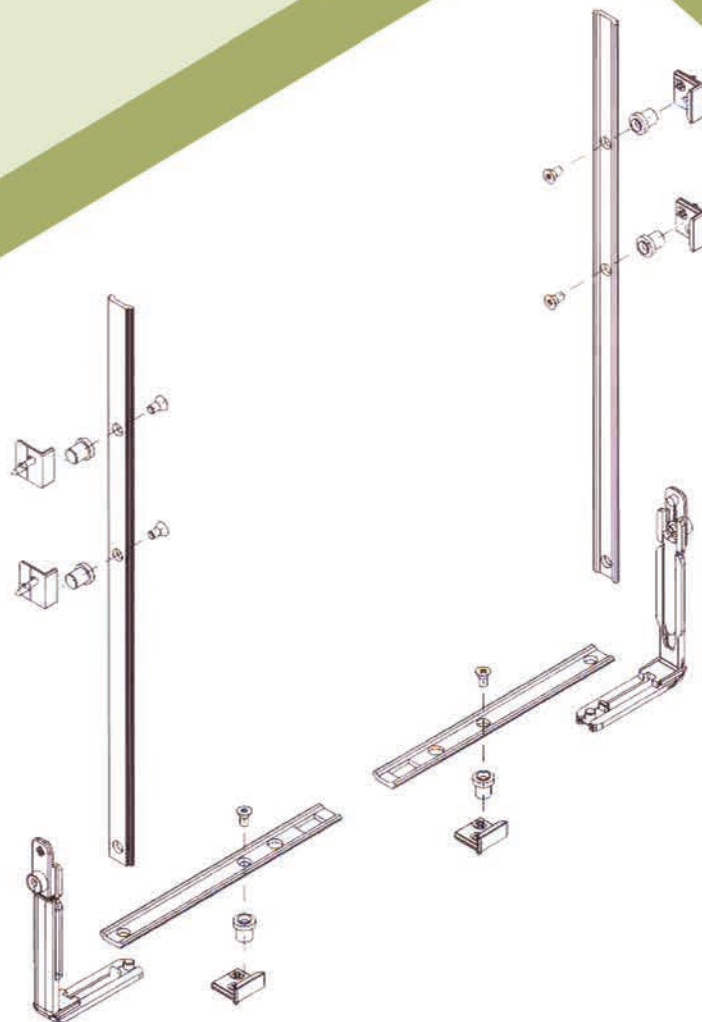

CURTAIN WALL LOCKING ACCESSORIES

C-AD 115

Functions

Fastening element to be applied directly onto the rods in the range.
It permits adjusting the force of the pull by simply turning the eccentric part

Technical features

Simple and quick to apply by simply making a hole diam. 8mm on the rod.
Permits making one or more supplementary fastenings on any frame.
Offers the possibility of adjusting the force of the closing pull

Materials

Zamak base and pawl
Stainless steel screws

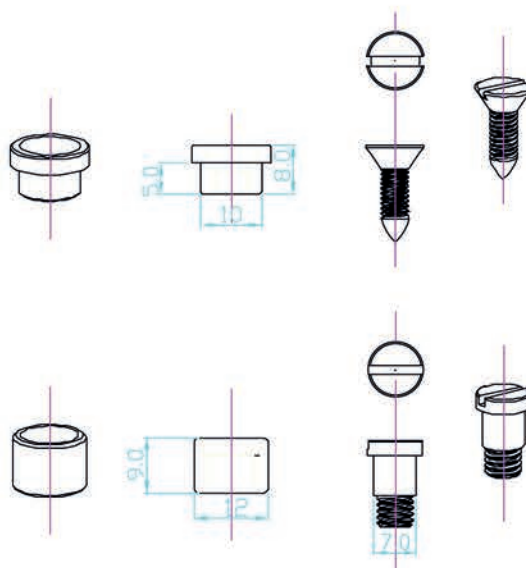
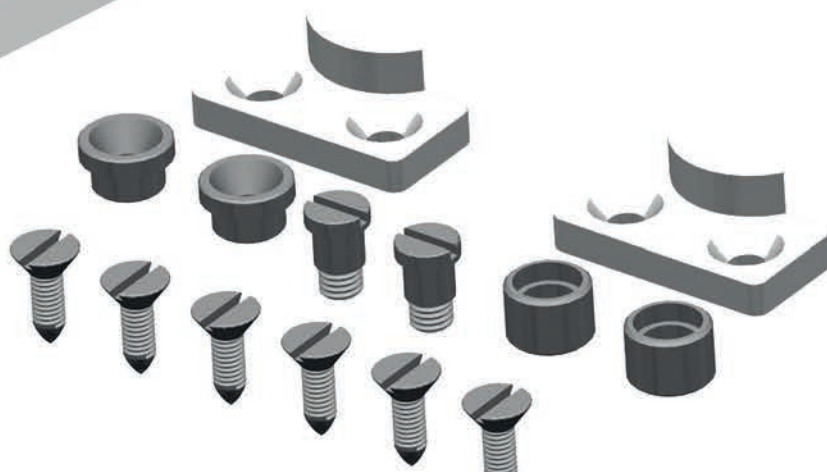
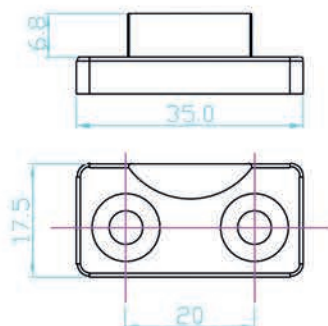
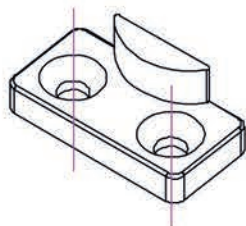

Adjustable Fastening Pawl

Functions

Fastening element to be applied directly onto the rods in the range.
It permits adjusting the force of the pull by simply turning the eccentric part

Technical features

Simple and quick to apply by simply making a hole diam. 8mm on the rod.
Permits making one or more supplementary fastenings on any frame.
Offers the possibility of adjusting the force of the closing pull

Materials

Zamak base and pawl
Stainless steel screws

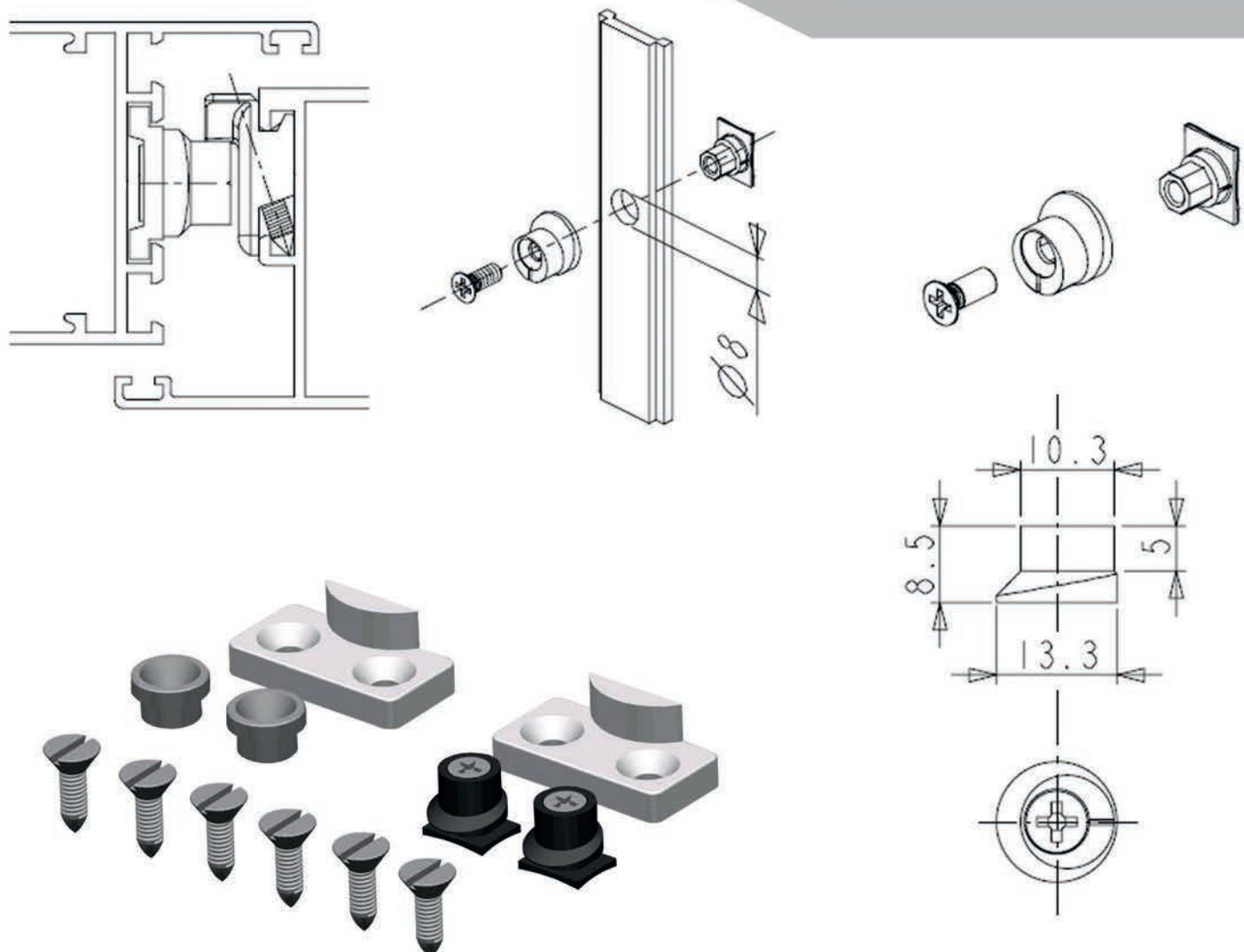

C-AD 117

Middle Window Handle

Middle window handle come with S.Steel bolt easy to fix for top hung window.

Finishing : Painted in RAL colors

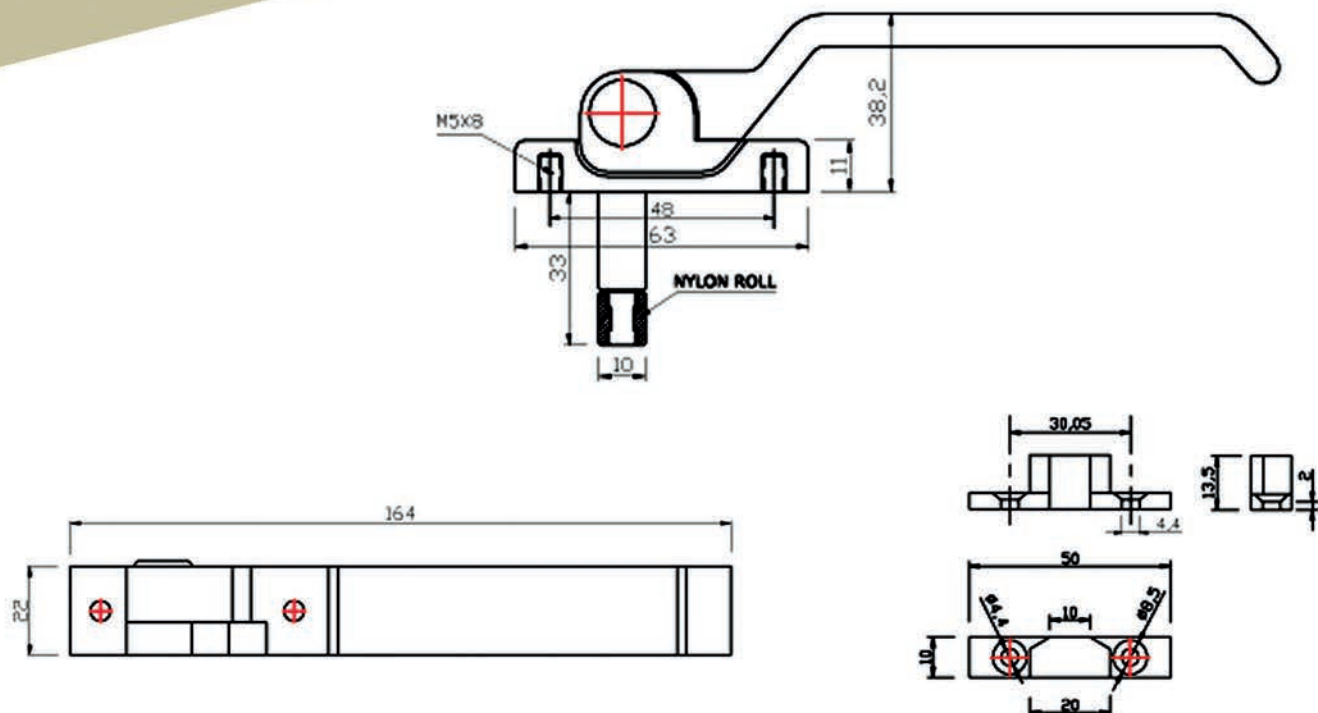

Two direction mechanism

The two direction device for moving rods in wing systems, housed inside the tabular part of the profile, this device can be applied to left or right windows, without special fitting.

Comes with window handle made in die-cast aluminum, the handle present a special spring-loaded mechanism that allows to return the handle in a 90 degree upright position, the center-to-center distance is 43mm. and complete kit for the closing one-winged windows, consisting of two nylon connection for device, two rod end, two check plates, made from nylon.

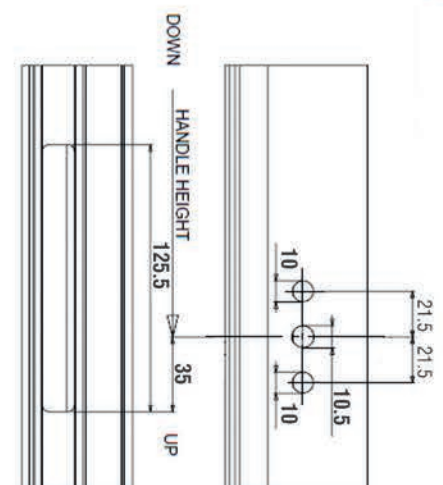
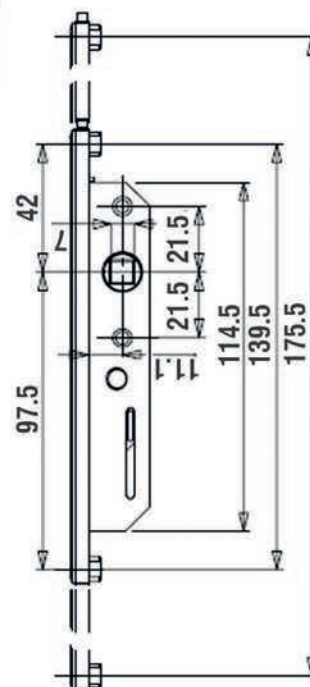
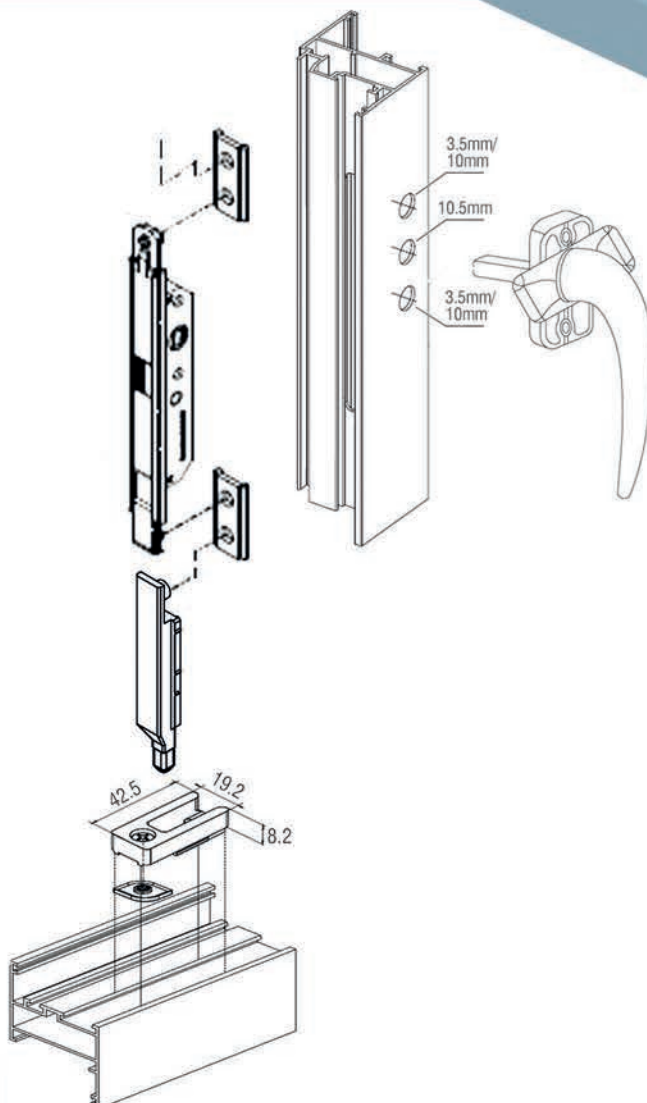

Lever bolt

C-AD 119

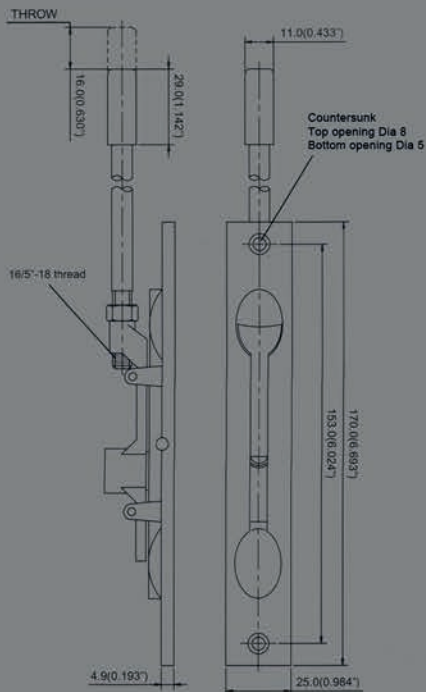

Lever bolt with embedded fitting ,
extremely strong suitable .
also on door profile with closing by internal rod .

Materials :
Zamak body and galvanized steel rod .

Finishing : Painted in RAL colors

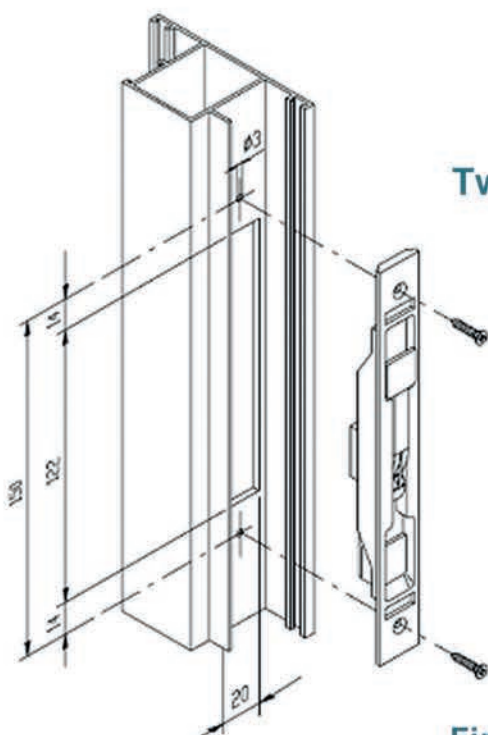

Two Directional Lever Bolt

C-AD 119 D

Applications
Two directional lever bolt extremely strong suitable
also on door of new design.

Characteristics
Useful travel 18mm
With lever operation it is possible to transmit a force
of up 180 kg to the rod.
It is flush-mounted and can accommodate indistinctly
sliding rods dia-meter 6mm or 8mm because it is
already fitted with a dual threading diameter .
Parts supplied
2 black stainless steel 7P*1/2" flat head c/sunk screws.
Materials
Die-cast zamak body and lever hardened
steel springs.

Finishing : Painted in RAL colors



NYLON BOLT

Nylon bolt consisting of a sliding body and a terminal with lock pin for direct fixing to the floor. Designed for use with aluminium open joint door and window frames.

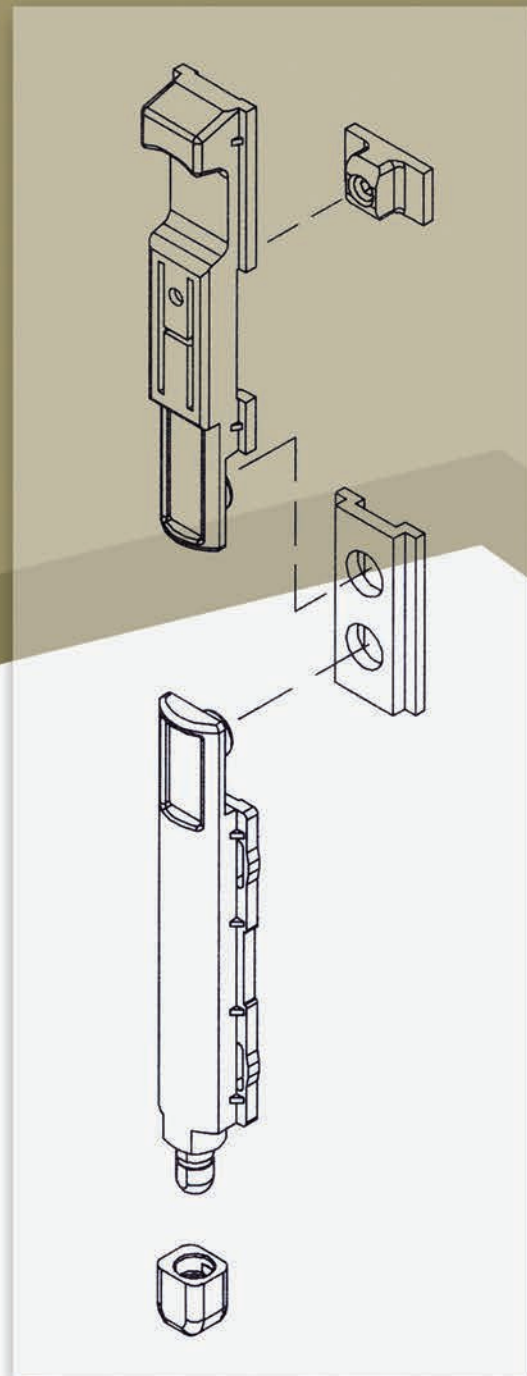

NYLON (FINGER CATCH)

Nylon catch has soft and rounded shapes and easy ringing nylon grip. Equipped with of an exclusive fixing system that helps the correct placing of the body and the counter plate. Perfect use on complanate and surmount (+7mm) systems with the 2 counter plates. Additional thicknesses of 1,2,3 mm compatible with both counter plates (usable for surmount systems till 13mm). Nylon body. counter plates and thicknesses; tempered steel helical spring; black galvanized steel fixing screws 03,5 TSPC CR.

Nylon ratchet "RING" is universal for the PVC, WOOD, ALUMINIUM AND WOOD-ALUMINIUM profiles. It is also adaptable for the surmount systems (15-28mm).

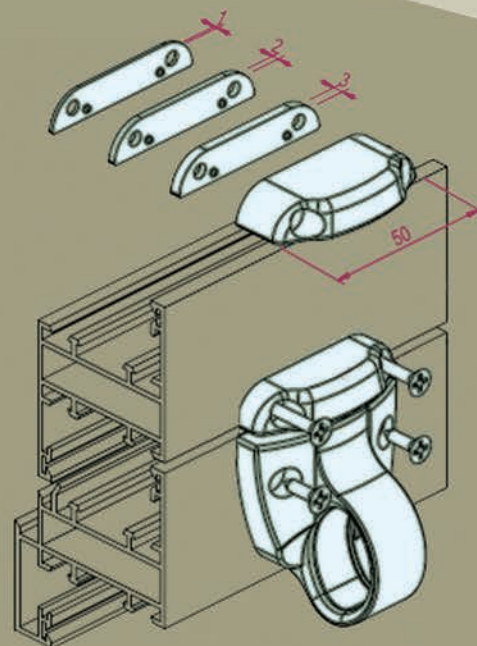
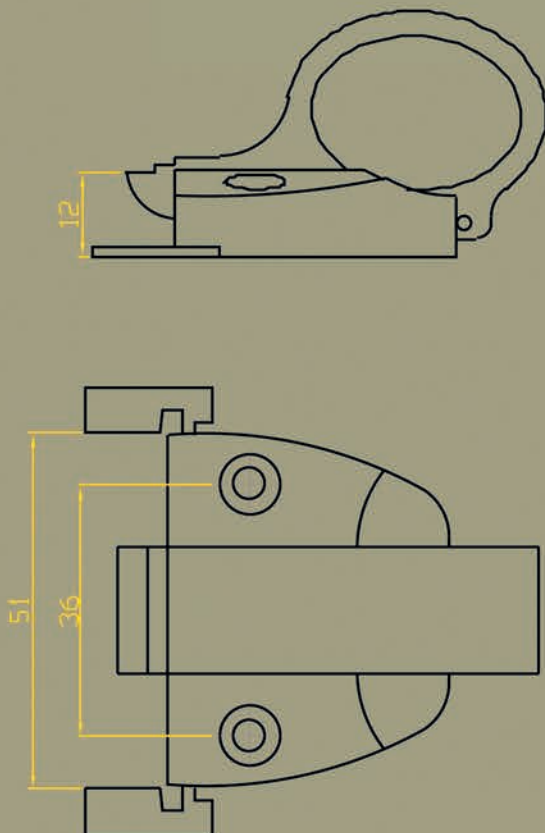

C-AD 122

QUICK FINGER CATCH

Applications

Fastener for bottom-hung windows. with clip, quick to install and very secure (needs no machining on the profile).

Finishes

Anodized black

Characteristics

Utilizing cam plates makes for quick and secure fixing, with no machining on the profile.

No striker required on the frame.

Equipped with s shim to be put on the toe to make up for any play

Parts supplied

2 cam plates

2 M5x10 crosshead screws

1 toe shim

Materials

Black nylon toe, shim and pull

Galvanized steel screws. pin and spring

Galvanized steel cam plates

Extruded aluminium body

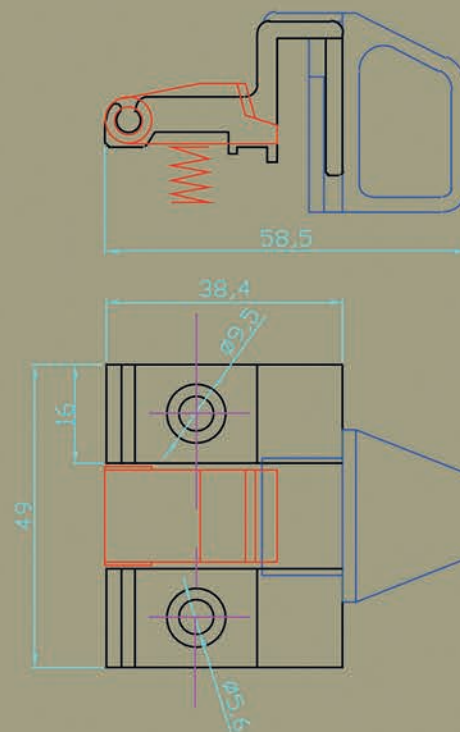
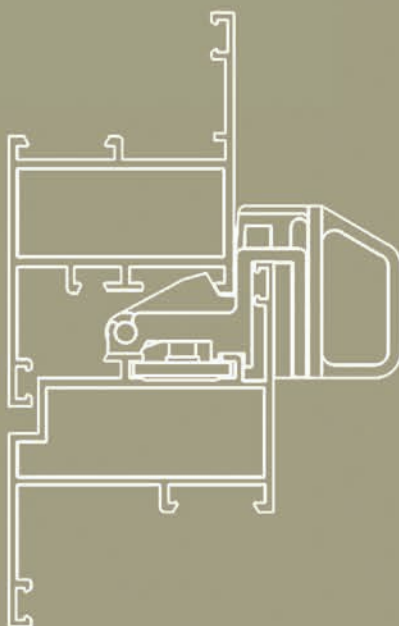

FINGER CATCH

C-AD 123

Fastener for bottom hung windows for external application, made of extruded with nylon internal guide. Quick to mount, it can be installed on any kind of section by using nylon packing.

Finishing : painted in RAL colors

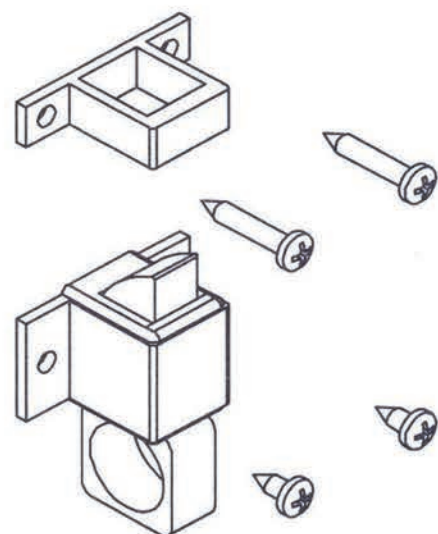
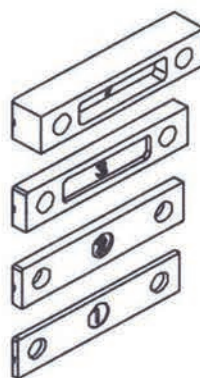
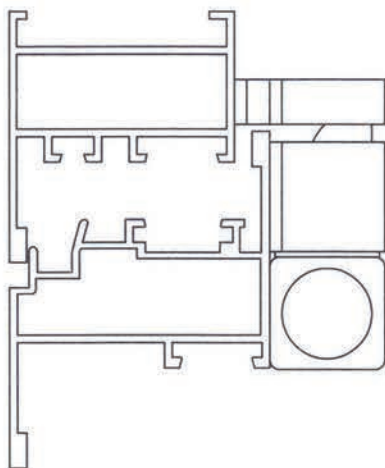

LIMIT ARM

The limiters could be mounted on the already installed windows (no profile machining, no holes). The innovative damping block from zamak covered with nitrilic rubber permits to deaden the hitting in the case of accidental window opening.

The lever from stainless steel permits a fast coupling and uncoupling of the window leaf - making easy an outside glass cleaning .

The arms are from stainless steel, fixing blocks are from zamak.

Load capacity 70 kg, variable in consideration of the dimensions and the opening angle of the window-frame.

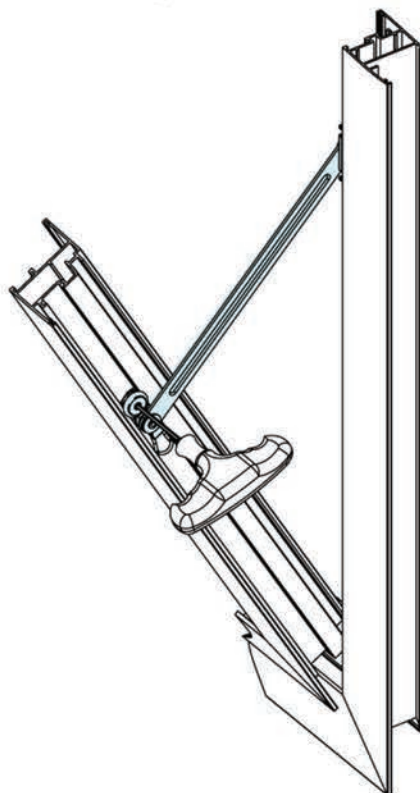
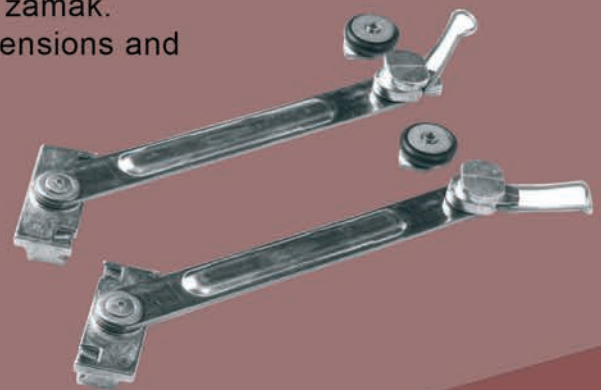

* Dual-sided Containment of Vent Bar to Prevent any Sash Play, plus Large Contact Area and Immediate "Pull-Inn" of Sash to Prevent Weather Strip Problems



* 304 sus Series Stainless Steel Arms

* 304 sus Series Stainless Steel Rivets

* Nylon Bearing Washers at all Pivot Points



* 304 sus Series Stainless Steel Track

* Solid Brass Shoe for smooth Long-lasting Performance

* Stainless Steel Hex Head Friction Adjuster for Fine Tension Adjustment

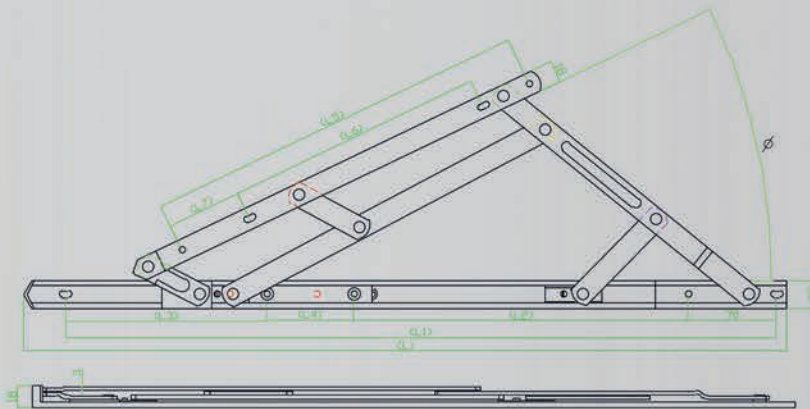

ADJUSTMENT BLOCKS

Optional cam adjustment device for +/- 2mm vertical adjustment by simple allen key operation. Suitable for use with all ADLER commercial hinges this product provides easy alignment of heavy vents on site.



MERIC HINGES SIZING CHART

SIZE	(L)	(L1)	(L2)	(L3)	(L4)	(L5)	(L6)	(L7)	Ø
16"	413	373	109	140	70	200	100	60	30
18"	464	424	139	150	70	228	126	60	30
22"	562	523	219	159	70	287	184	60	25
24"	615	573	270	162	70	310	209	60	20
28"	718	678	345	185	70	360	258	60	20

FRECTION HINGES ATTRACTIVE

Stainless Steel, Heavy-Duty, Four to six - Bar Hinges for Projection Windows

FEATURES:

- Fits existing window tooling for center mount installation - No tooling changes required
- Specifically developed track & cap lubrication
- Reinforced collector cap tested to 1970 PSF design pressures without permanent deflection
- "Gap-Tight" technology assures +/- .25mm weatherseal gap (patent pending)



Item	Stack height	bar thickness	bar number	max.vent height/mm	max.vent width/mm	max.vent weight/kg	opening angle °
ADLA 200-16" T	18mm	3mm	4	1200	1200	75	30
ADLA 200-18" ST	18mm	3mm	6	1400	1500	100	30
ADLA 200-22" ST	18mm	3mm	6	1500	1500	112	25
ADLA 200-24" ST	18mm	3mm	6	1600	1500	120	20
ADLA 200-28" ST	18mm	3mm	6	2000	1500	150	20

Stay arm

Restrictor are available in any combination of standard Track lengths(8",10",12")

Size: (8",10",12")

Finishing

Stainless Steel : Track, Arm, Bracket, Rivets, Screws. Brass shoe. Delrin Friction Pad.

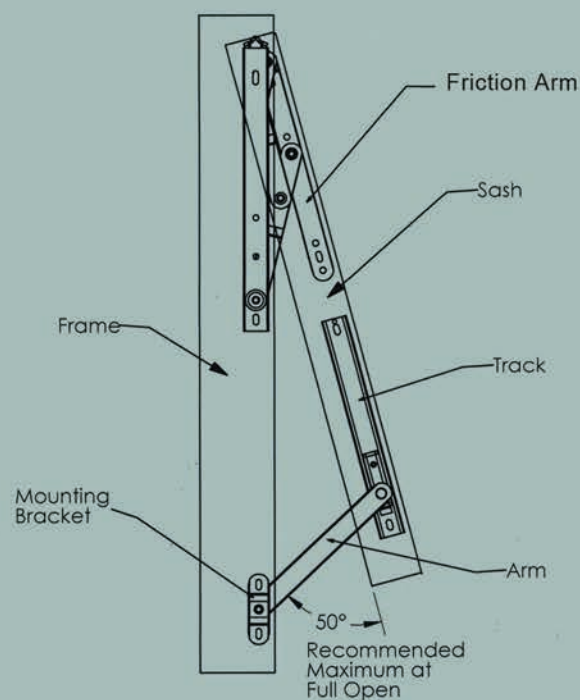
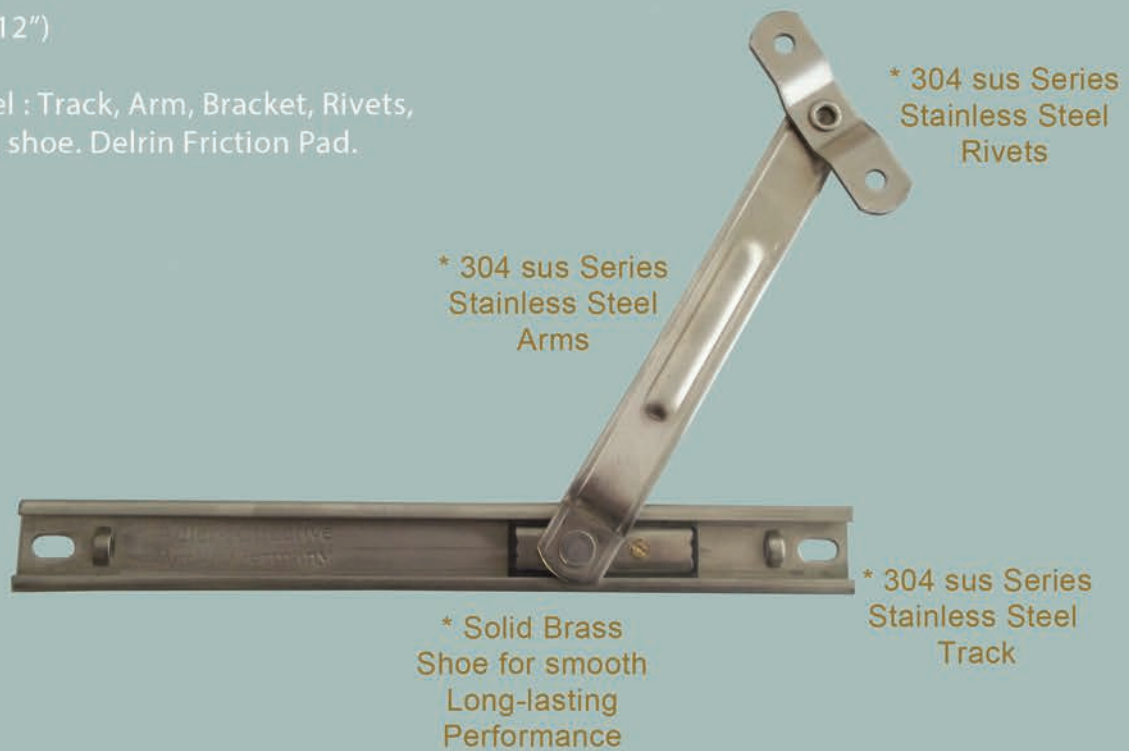

Sliding Thermal Break Fitting

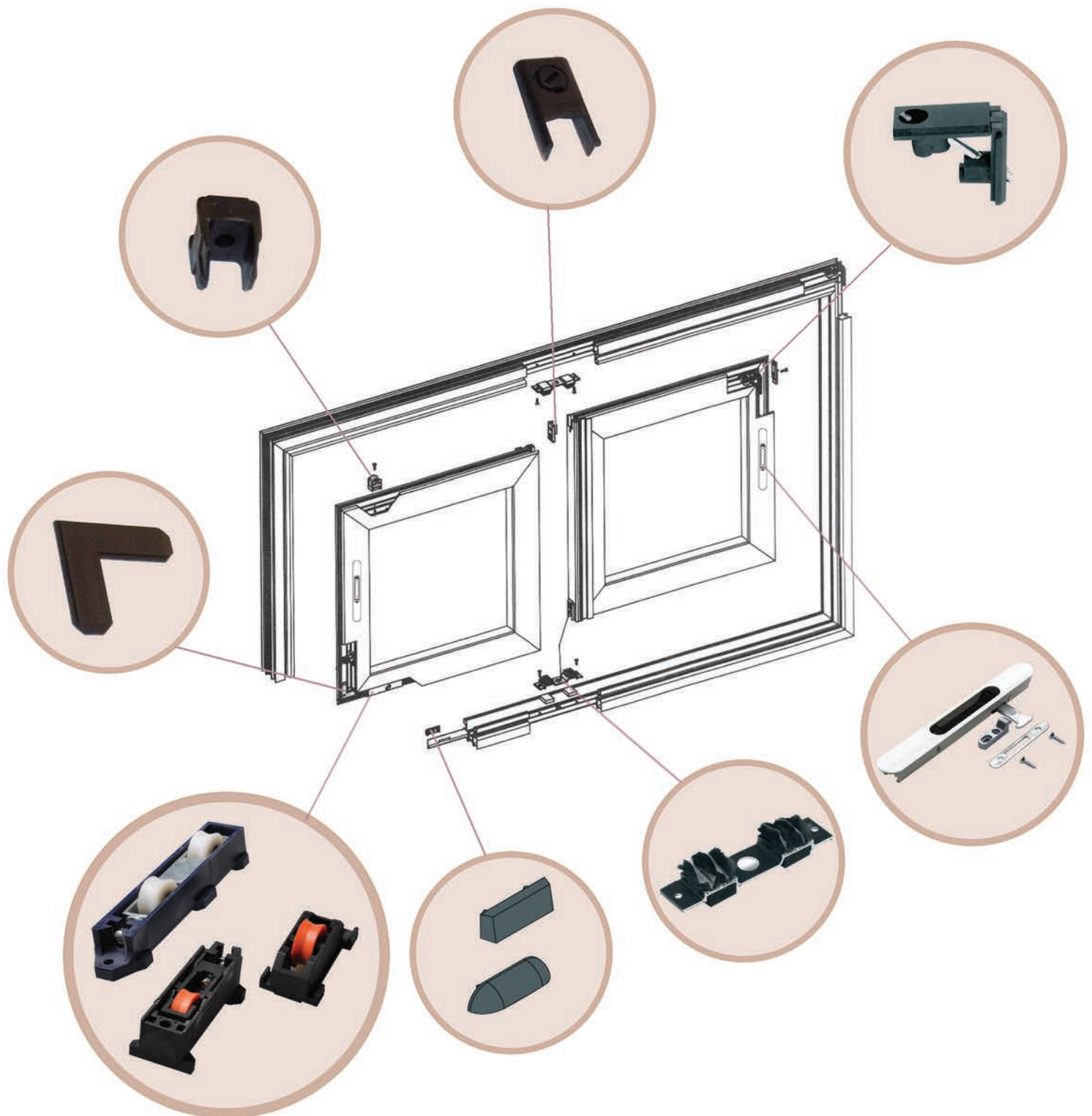

Sliding handle

Sliding Door Handle, two handle flush with the possibility of manual for door or automatic use (for Windows). The side closing of sliding doors and windows, the sliding handle permits the crossing and over lapping of the two (2) wings. The sliding handle is secured to the profile quickly and precisely first inserting the bottom part of the handle in the slot and then pressing hard on the top part.

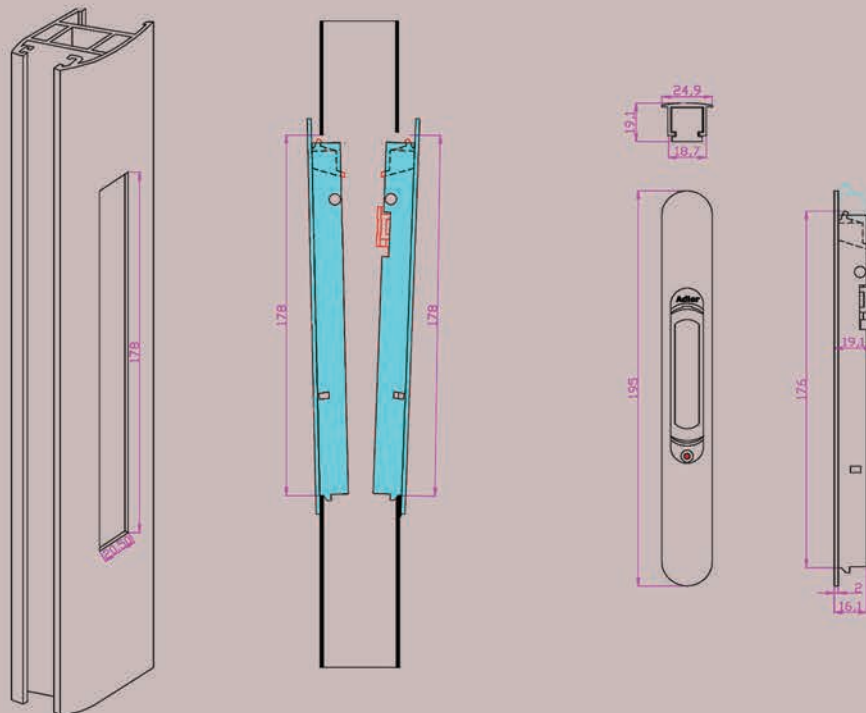

Sliding handle

-Tow-handle flush mounted handle with automatic connector for side closing and simultaneous crossing over of the wings of a sliding aluminium window. Comes with the kit compares a hook that offers maximum reliability and resistance over time, and a counter plate that guarantees a secure lock.

Technical features:

-The sliding handle is set up for automatic functioning therefore only use this article on sliding aluminium window, The hook is adjusted manually when the handle is fitted, the hood is secured definitively by adjusting a grub screw at the front keeping the nylon recess lowered.

Finish: painting in RAL colors

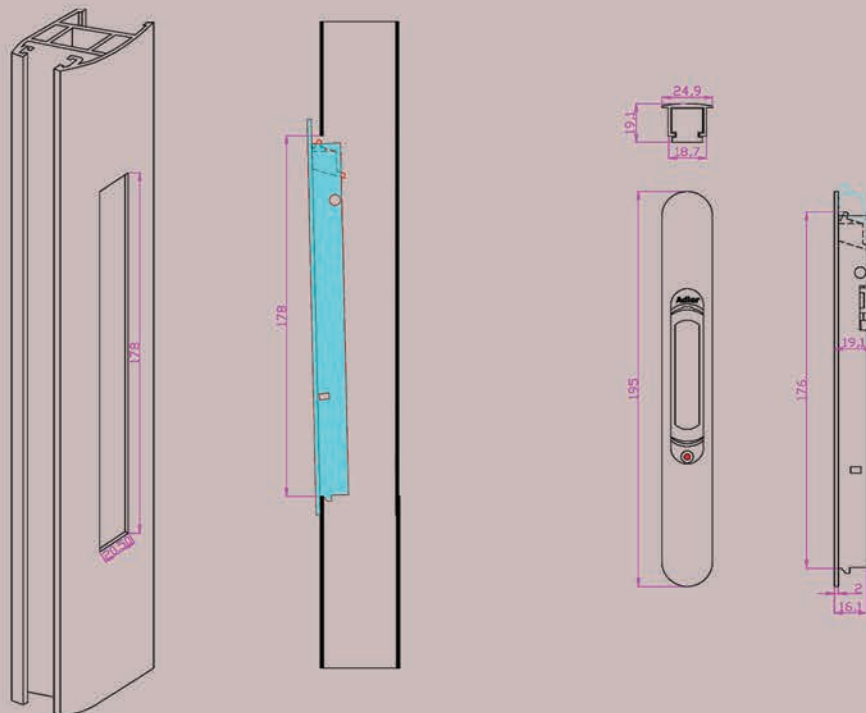
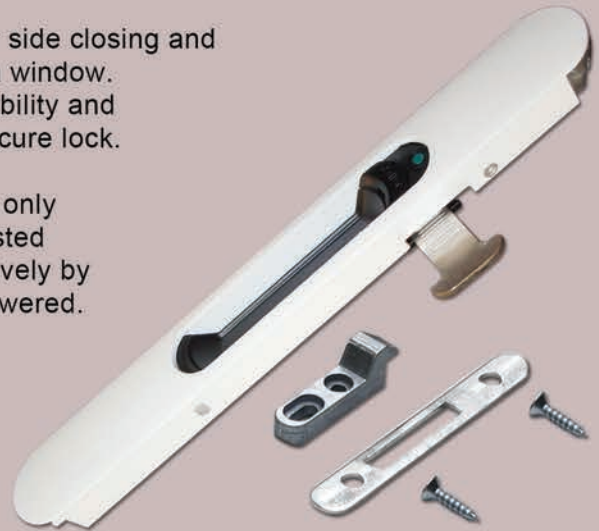

C-AD 134

Sliding Handle Thumb Lock

Sliding handle thumb lock two-handed flush-mounted handle with automatic connector for side closing and simultaneous crossing-over of the wings of a sliding aluminium window and doors.



- The sliding handle is set up for automatic functioning.
Therefore, only use this article on sliding aluminium windows and doors.
- The sliding handle is secured quickly and safely.

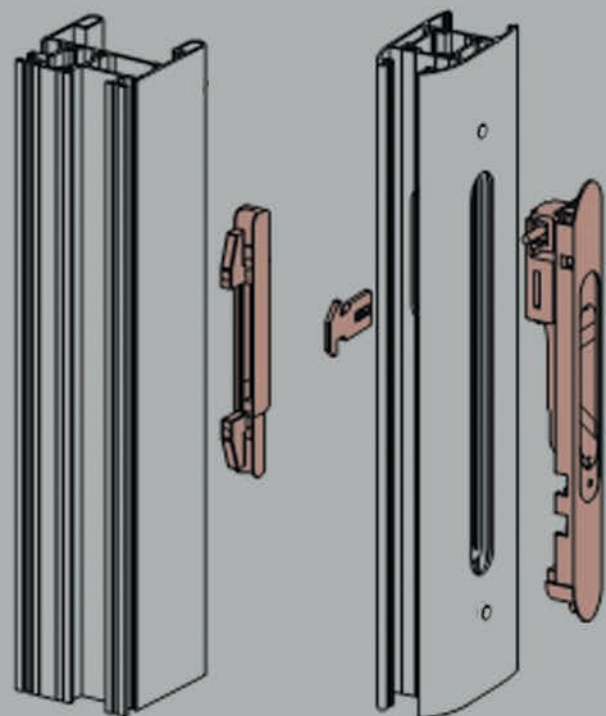

Sliding Handle Thumb lock

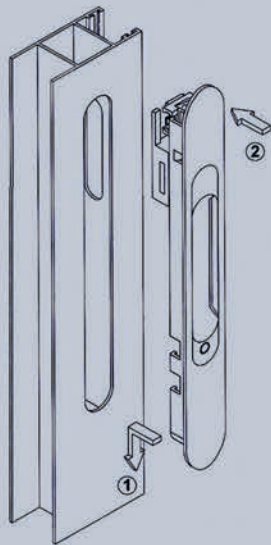

- 1- FIX THE BOTTOM EDGE INTO THE GROOVE
- 2- PUSH IN THE TOP EDGE FOR THE FIXING HANDLE

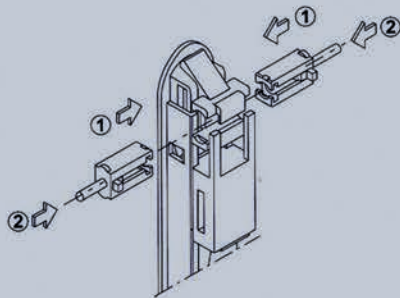

THE SAFETY LOCKING INSERT CAN BE FIX IN BOTH DIRECTION AND THAT IS ACCORDANCE TO THE WINDOW DIRECTION.

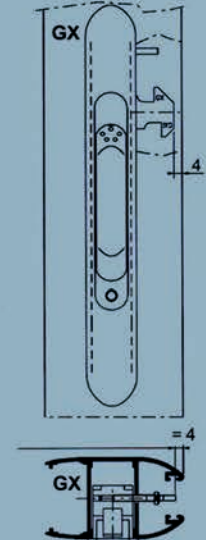
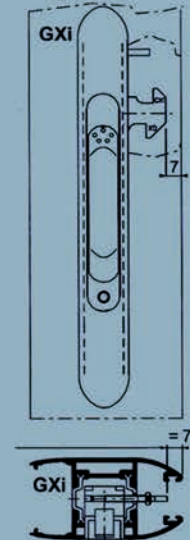
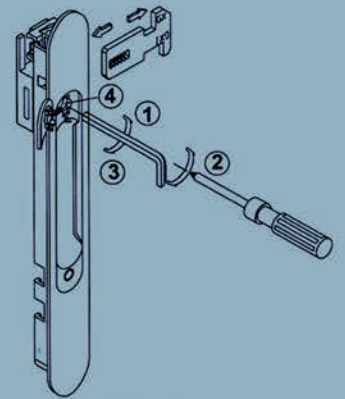
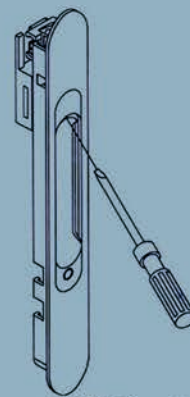

FOR REMOVING THE SLIDING HANDLE:

1. REMOVE THE SAFETY LOCKING INSERT BY HAND.
2. REMOVE THE SCREW PLASTIC COVER.
3. REMOVE THE STRICKER AFTER LOOSING THE SCREW BY-KEY.
4. INSERT SCREW DRIVER THOUGH THE STRICKER SLOT (SEE DRAWING 4).
5. PULL THE SCREW DRIVER TO YOUR DIRECTION FOR PUSHING DOWN THE ZINC PART.
6. TAKE OUT THE SLIDING HANDLE.

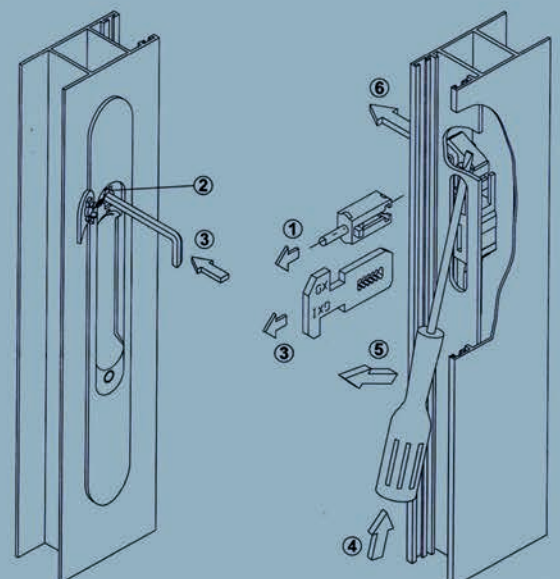

Half Moon Sliding Pull Handle

Additional pull handle, combined with window or door sliding lock handle, allows the final user to move and handle a sliding window and door wing easily without any effort.

Materials:

Die-cast zamak body

Finish:

Painting in RAL colours

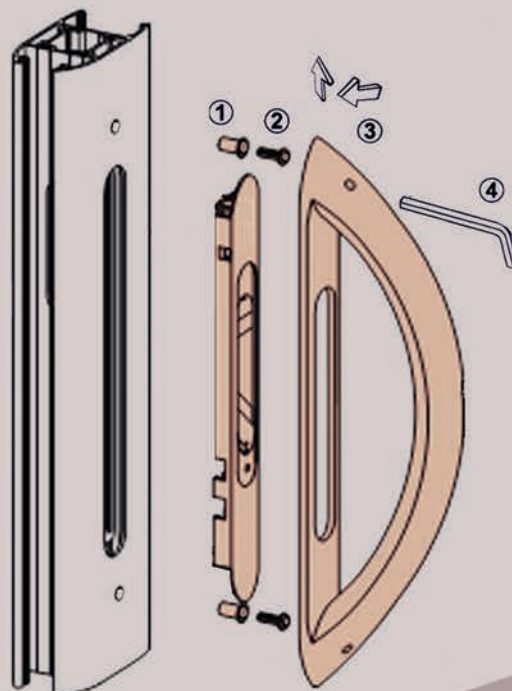

Central sliding handle

Closing central handle for sliding windows & doors, equipped with safety button, the handle features a lock mechanism which operates the locking system for enhanced security, the handle is made from die-cast aluminum, while the body, containing the mechanism, is fiberglass reinforced-reinforced nylon.

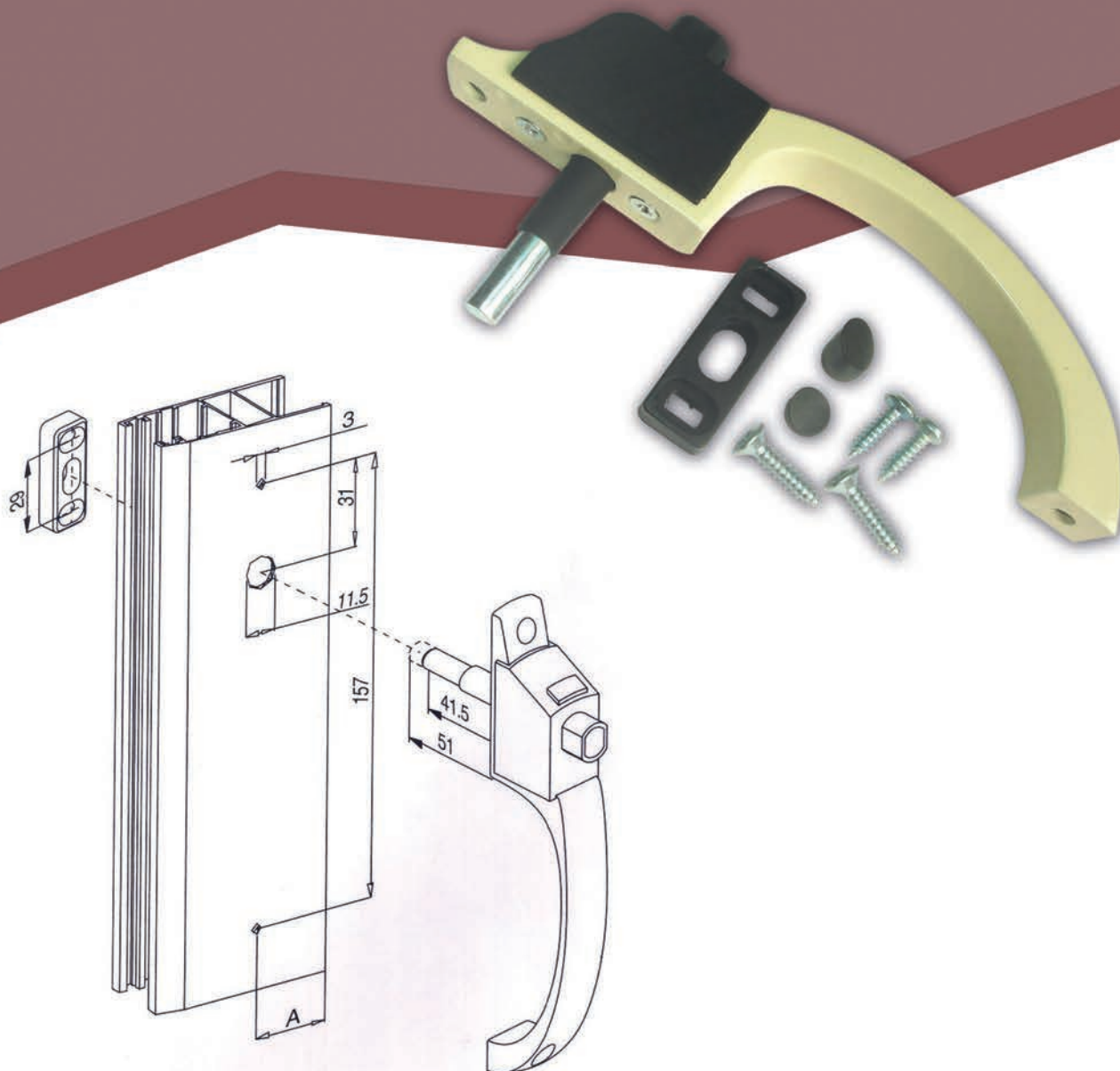

C-AD 138

Flush-mounted handle

Flush-mounted handle for side lock on sliding window, this handle has a different control lever from adler model, it is now in round shape, the body made from aluminum, control lever from nylon while the mechanisms are made from zamak .

Supplied parts

- 1-2 self-tapping hex, head screws
- 2- 1 stainless steel hook
- 3- 1 stainless steel check plate
- 4- Zamak check plate

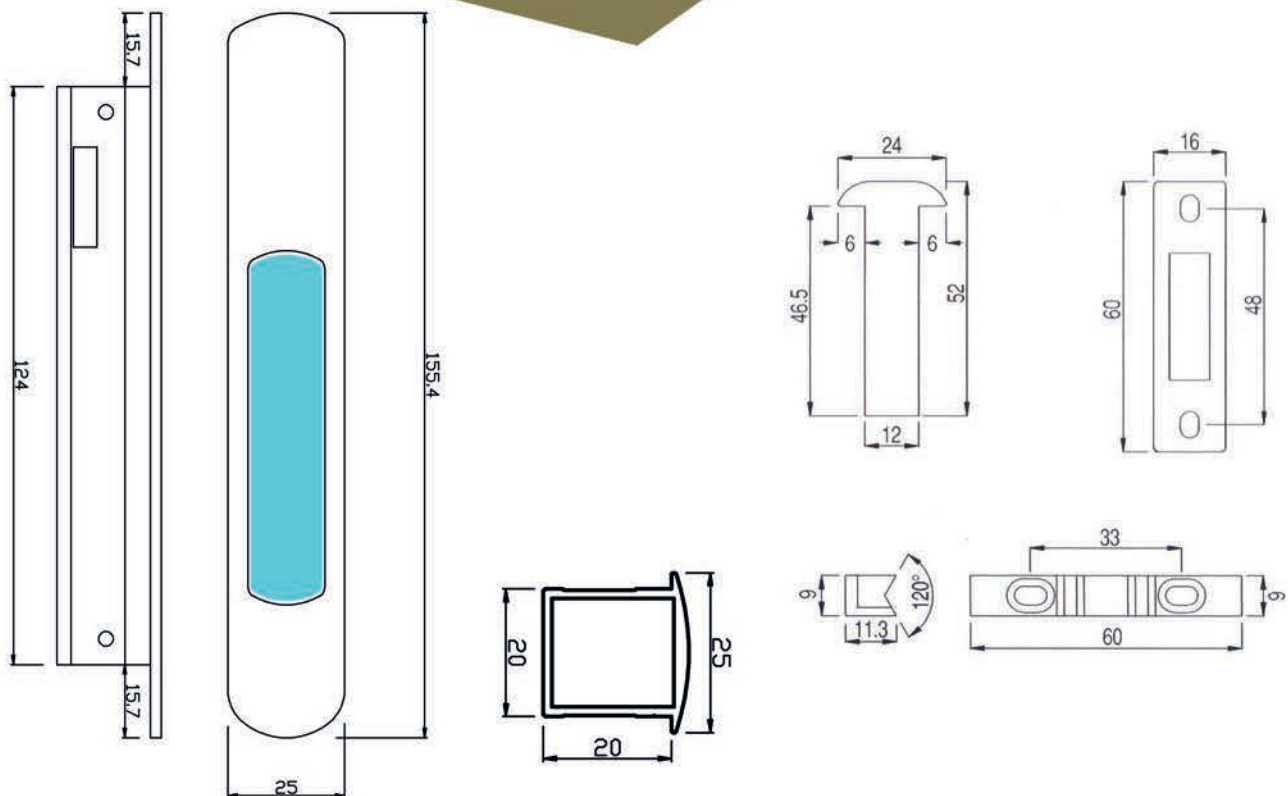

External Aluminium Sliding Pull Handle

External pull handel permits easy moring and handling of a sliding door from the outside. Assenbly is fastand precise, Drill two perfect lyaligned and a lots on the wing upright.

Finishing : painted in RAL colors



Sliding thirmal break roller

*Adjustable heavy duty roller with adjustment by screw ,adjustment is easy since the adjusting screw is located inside, which facilitates insertion of the wrench even in awkward operating condition the wheels are mounted on ball bearings.
It is fixed with a clamping grub screw
Capacity of one roller: 110 kg

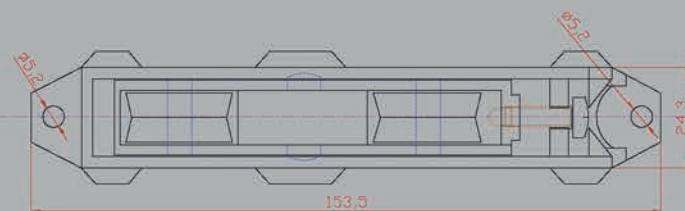
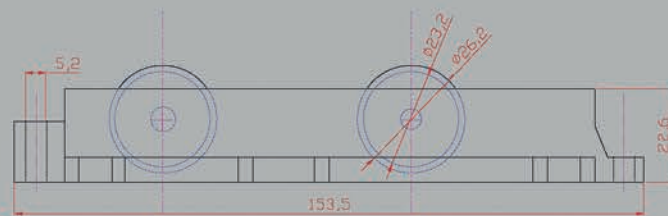
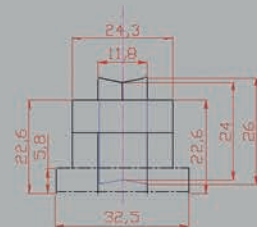
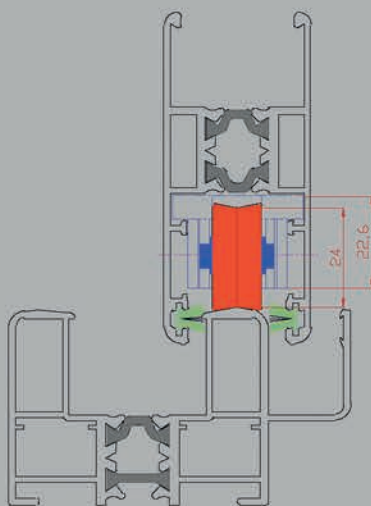

C-AD 141

Sliding thermal break roller

Sliding nylon roller

Available in tow versions :

*Adjustable roller with adjustment by screw ,adjustment is easy since the adjusting screw is located inside, which facilitates insertion of the wrench even in awkward operating condition the wheels are mounted on ball bearings.

It is fixed with a clamping grub screw

Capacity of one roller: 50 kg

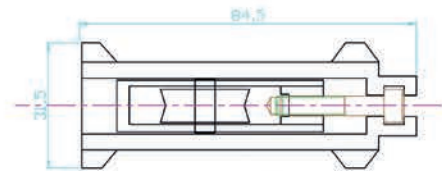
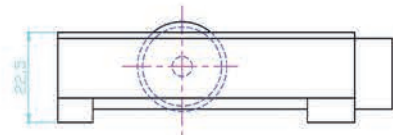
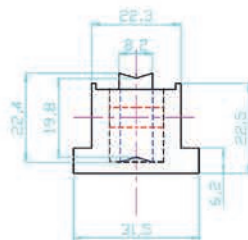
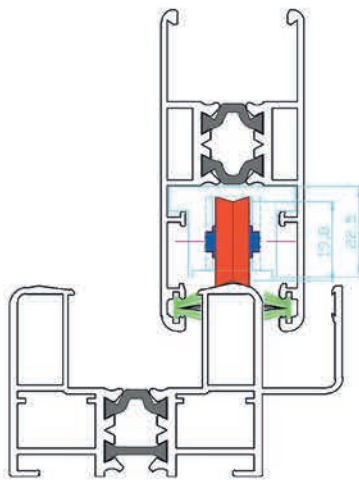

C-AD 142

*Fixed roller with the possibility of adjustment by inserting the wheel into one of its 3 possible positions .

the wheels are mounted on ball bearings.

It is fixed with a clamping grub screw

Capacity of one roller: 50 kg

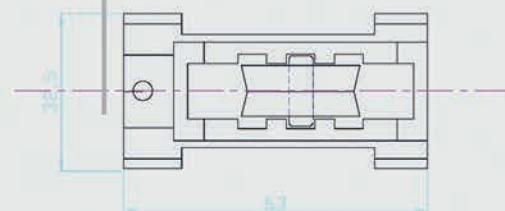
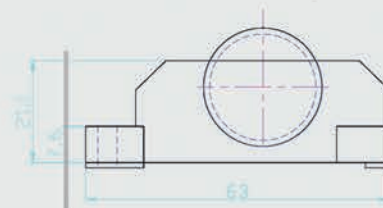
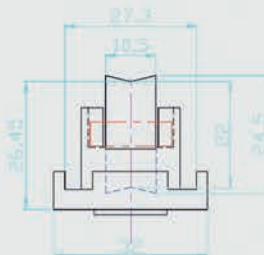
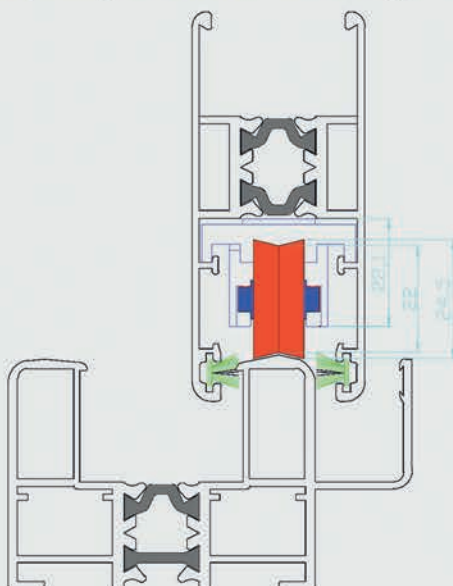

Sliding thirmal break roller Balance Double Wheel

C-AD 143

Two - wheel fixed roller with shielded ball bearings,
made from cast zamak for more strong body
to carry more weight
Capacity of one 2 roller: 150 kg

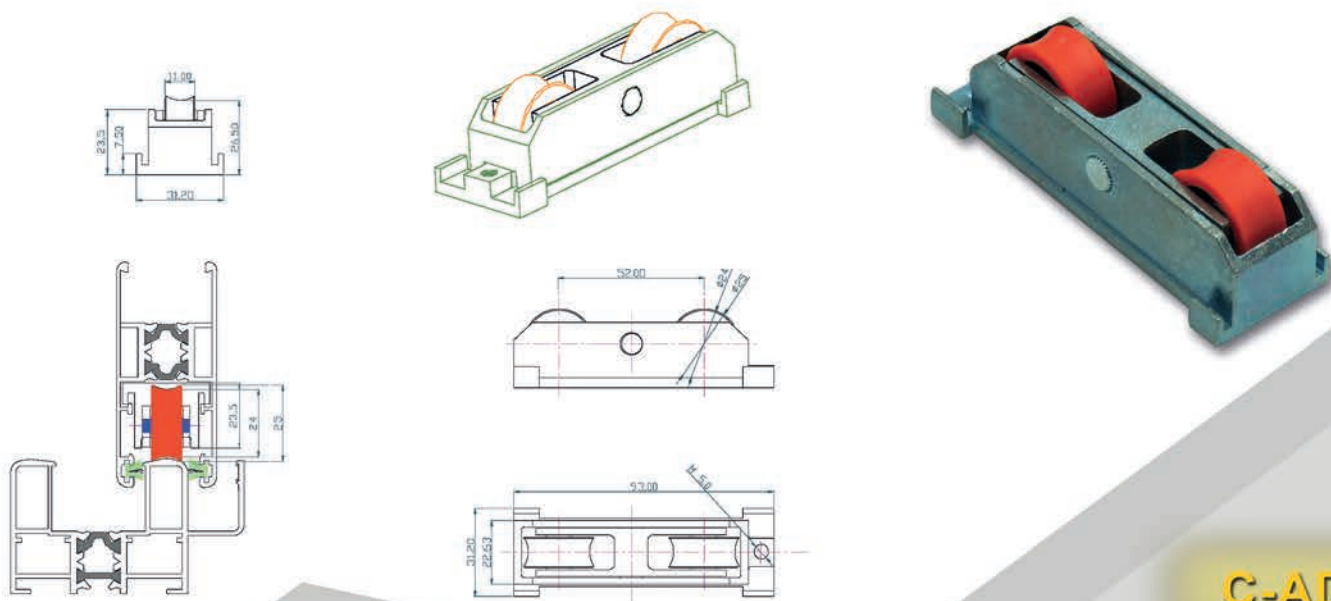

C-AD 144

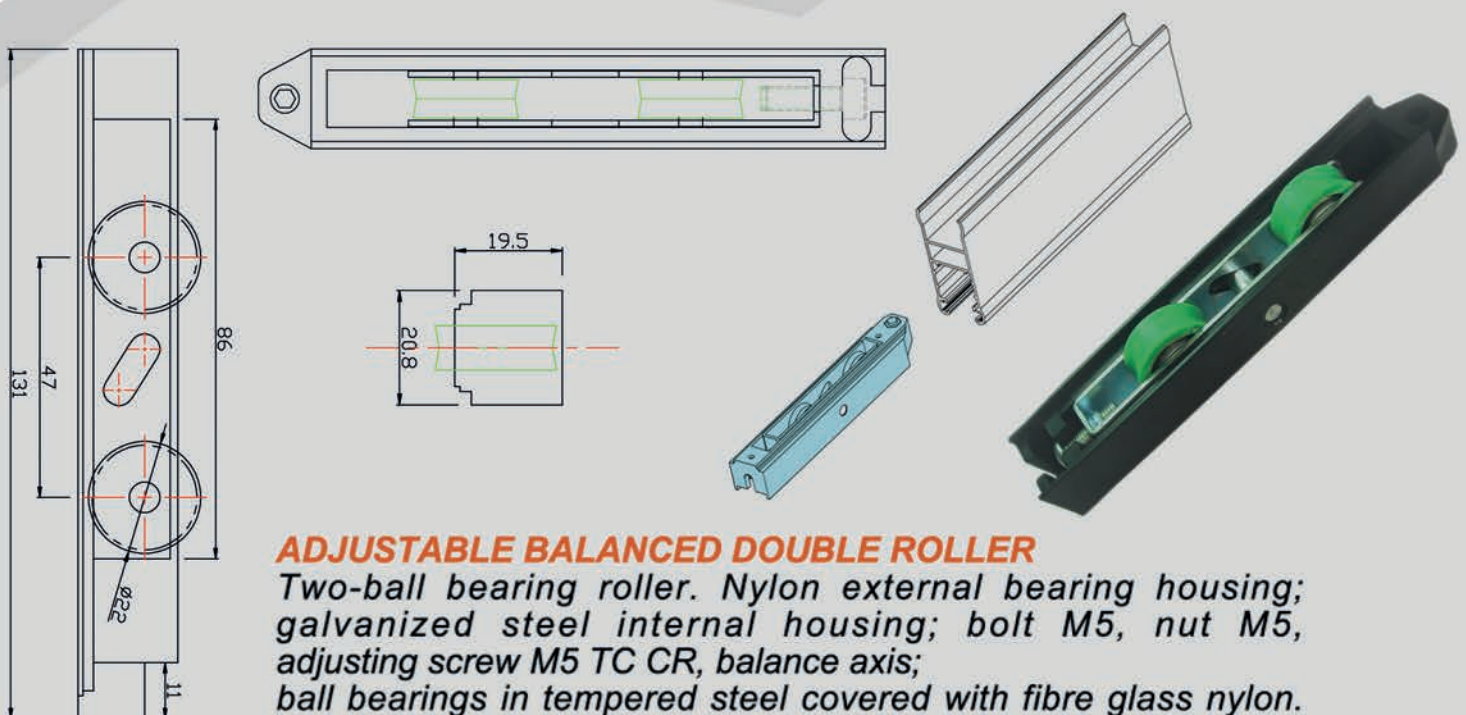

Aluminium Sliding Window and Door box roller

C-AD 145

Aluminum sliding window and door rollers.
Extruded aluminum with two wheels for sliding window and sliding door,
and the wheel is mounted on a ball bearing,
Capacity of one roller 100 kg.

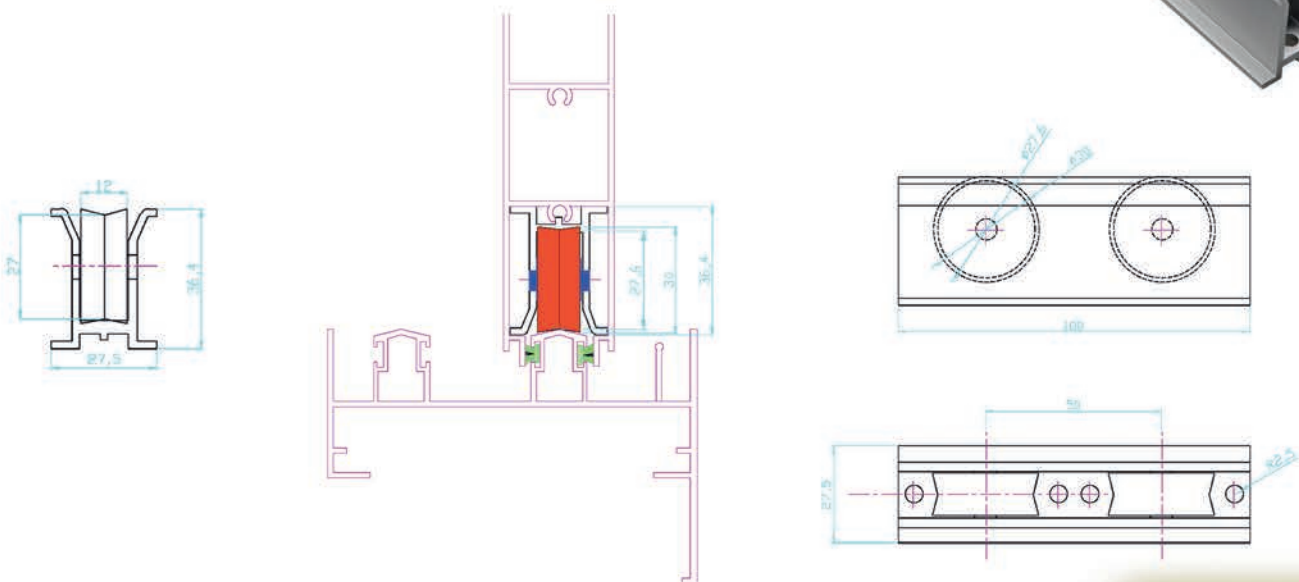

C-AD 146

Aluminum sliding window and door rollers.
Extruded aluminum with one wheel for sliding window and sliding door,
and the wheel is mounted on a ball bearing,
Capacity of one roller 50 kg.

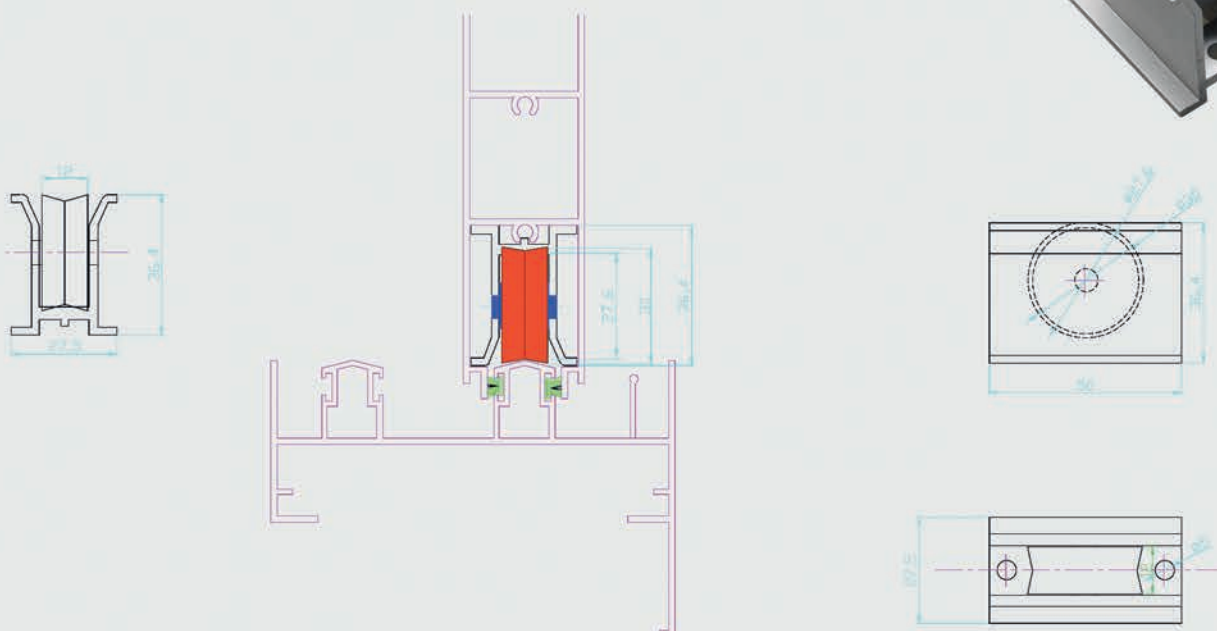

C-AD 147

Aluminium Sliding Window and Door box roller

Carriage extruded aluminium with one or two wheels for aluminium windows and doors sliding.

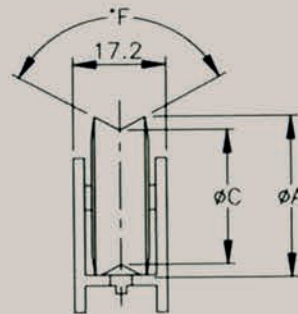
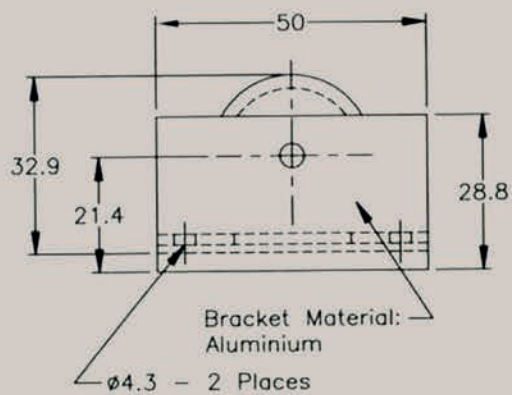

C-AD 147 D

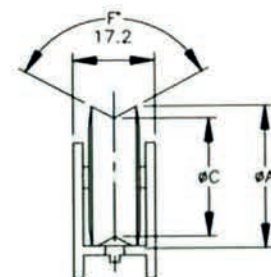
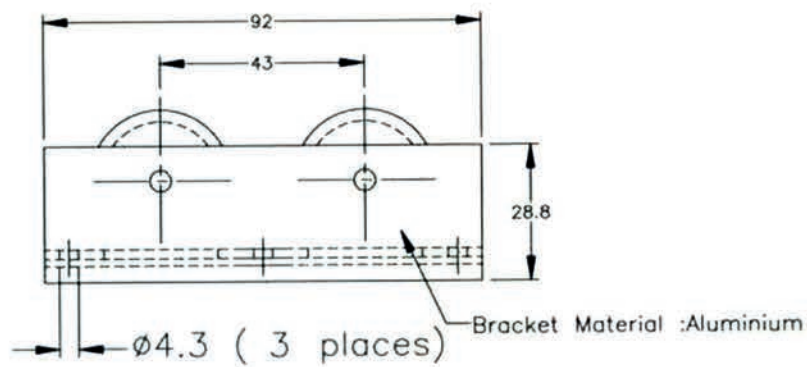
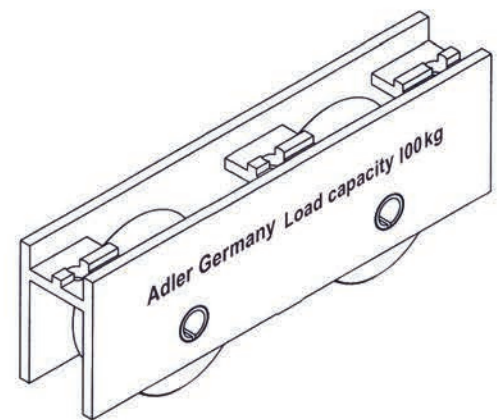

Nylon fly screen roller

Nylon housing with U shape
Nylon weel

C-AD 148

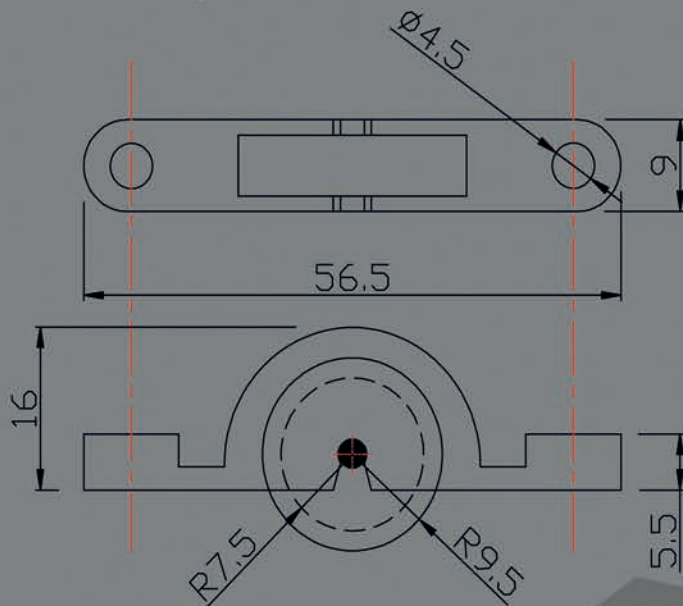

Non - Adjustable Roller

Steel housing with V shape
Nylon weels

C-AD 149S

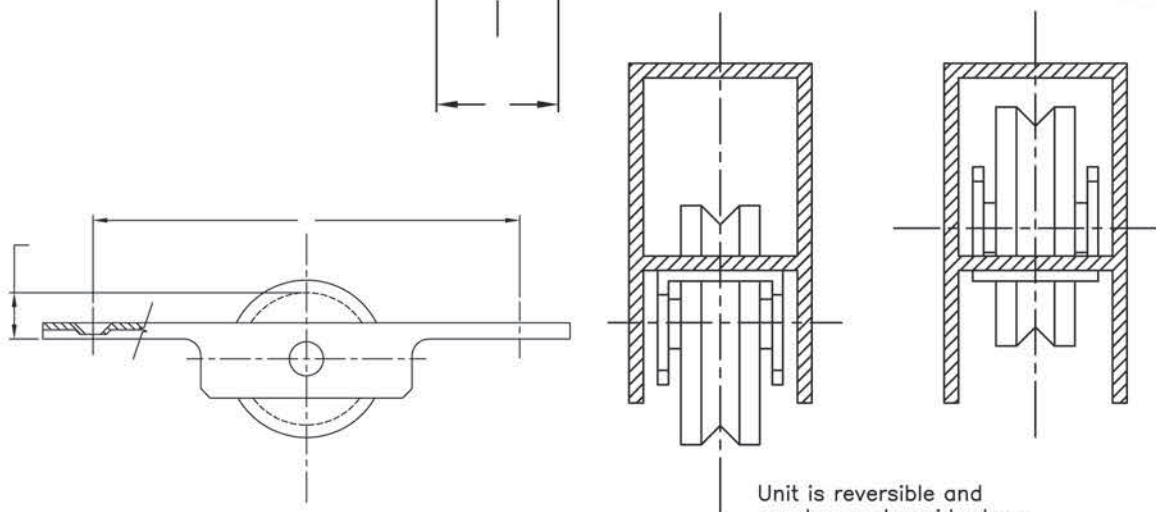
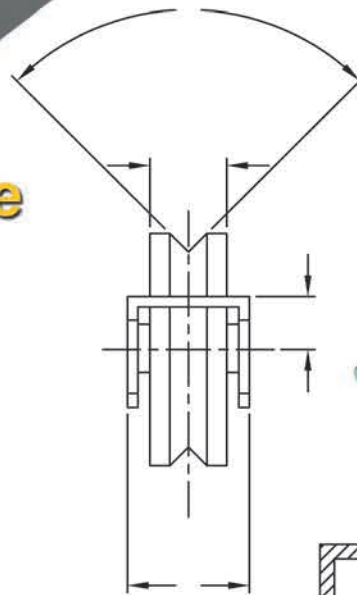

Unit is reversible and
can be used upside down.

Self Balance Double Roller

C-AD 149D

Specification :

- * Special roller for heavy sliding sash up to 120 kg.
- * Self balance to reduce the noise and to run smoothly and strength.

Material :

- * GI 2 mm sheet body to in sure durability and strength.
- * Boll bearing roller high quality.
- * Nylon bolemaid material to protect roller form high weather temperature and humidity.

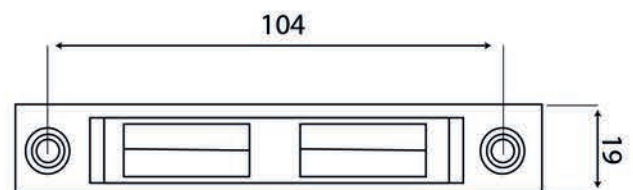
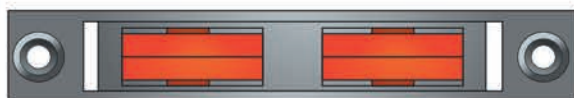
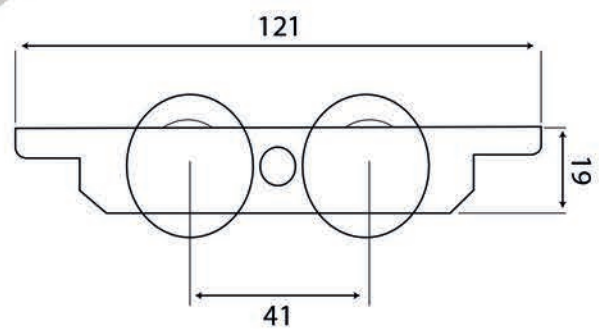
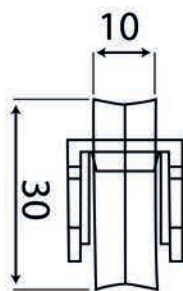
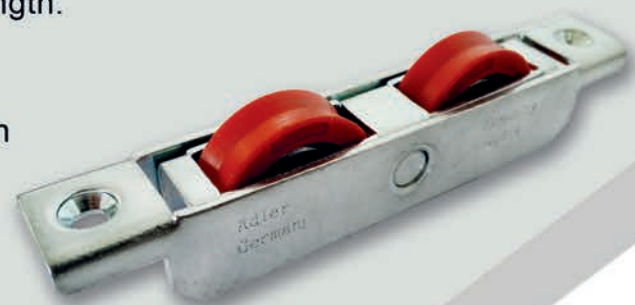

ALUMINIUM SWING DOOR HANDLE

Double bend Aluminium swing door handle to be applied in Aluminium doors,
It provide an ideal grip for heavy doors destined especially for public and commercial use.

Center To Center (CC) - 300mm
Handle Diameter (HD) - 32mm
Standard Finishes:
Powder Coated White
Powder Coated Black
Mill Finish
Painted Colors

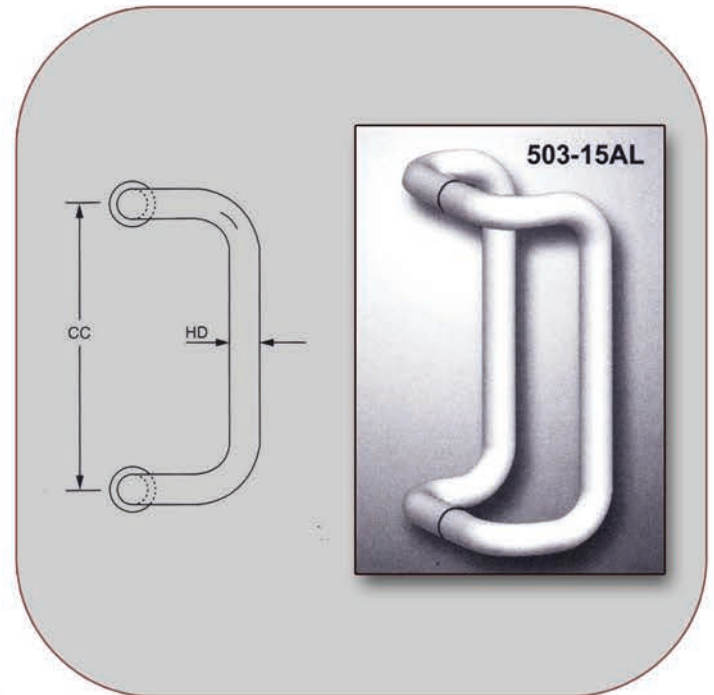

Center To Center (CC) - 300mm
Handle Diameter (HD) - 32mm
Standard Finishes:
Powder Coated White
Powder Coated Black
Mill Finish
Painted Colors

Sliding Accessories

Sliding Covering Plug

Plug to cover screws\holes on central jambs of doors\window and enable instrtion in a sliding rail.

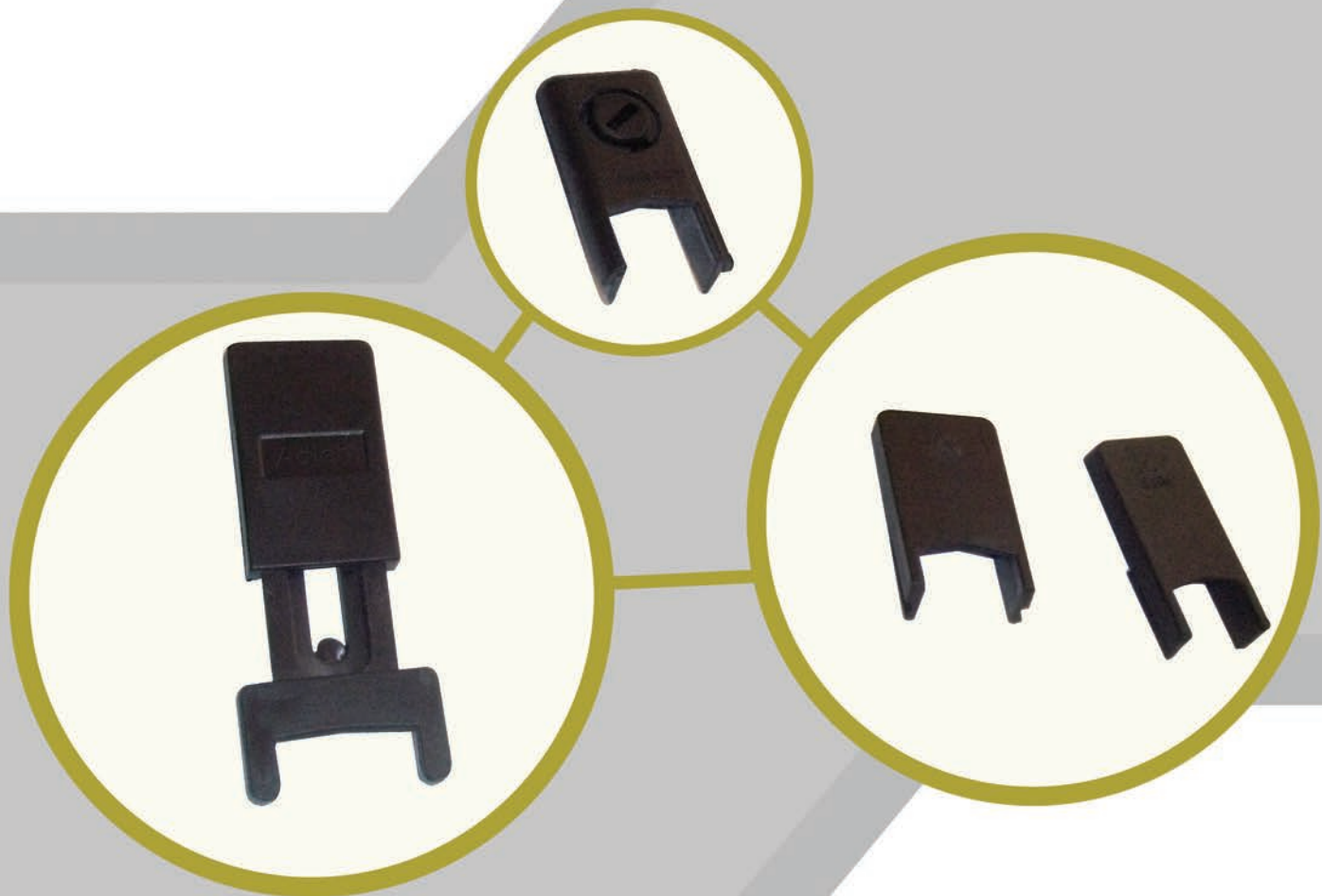

C-AD 150

Sliding Covering Plug

Plug to be fitted on the central profile to cover every kind of working. Nylon pin and closing pawl.

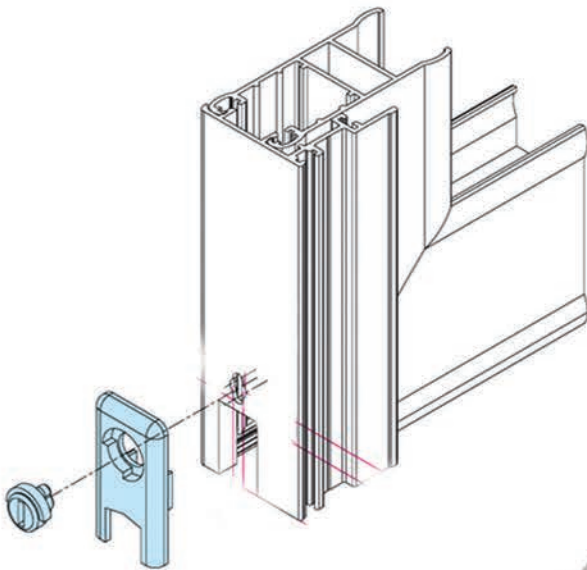

C-AD 151

Sliding Covering Plug

Plug to cover screws\holes on central jambs of doors\window and enable instrtion in a sliding rail.

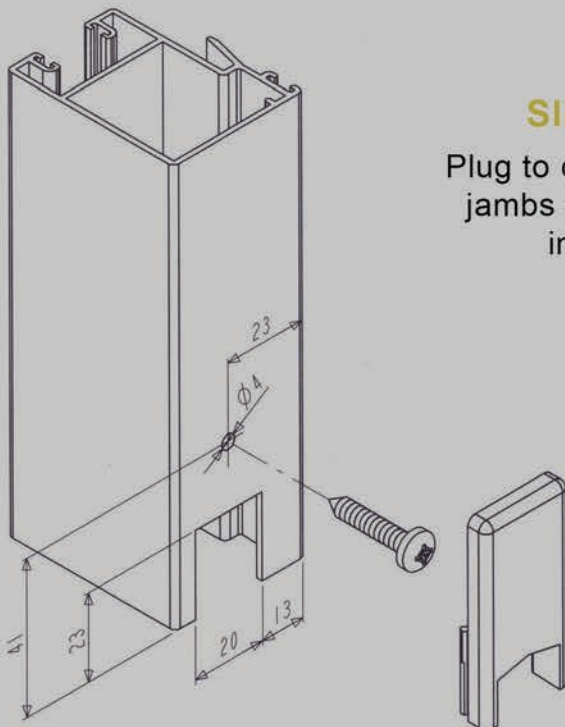

C-AD 152

Sliding Covering Plug

Plug to cover screws\holes on central jambs of doors\window and enable instrtion in a sliding rail.

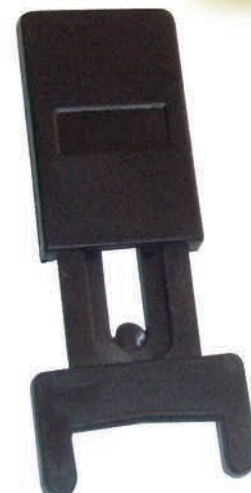

NYLON CORNER JOINT

Using in combination when assembling the window and door.
required to align the profile joints in the window or door when it is assembled.

C-AD 153



C-AD 154

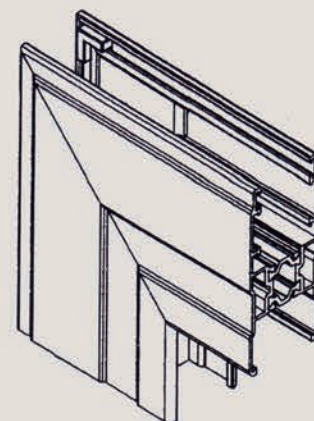
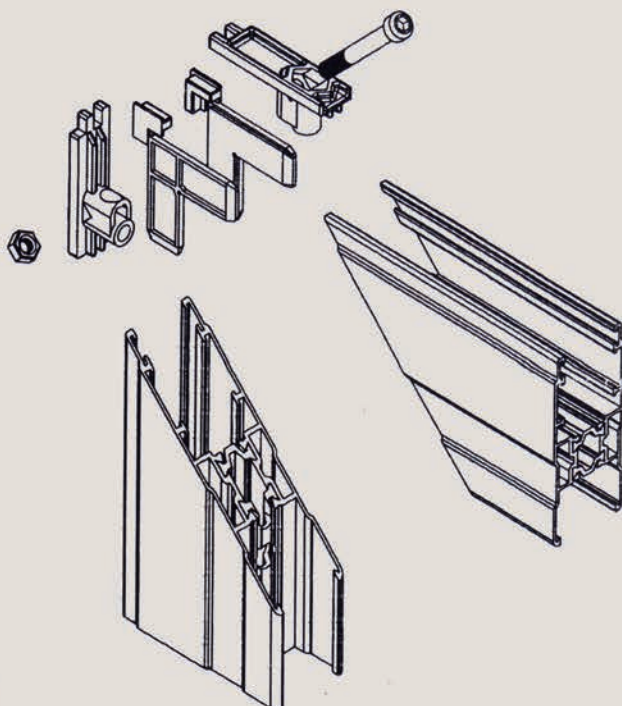
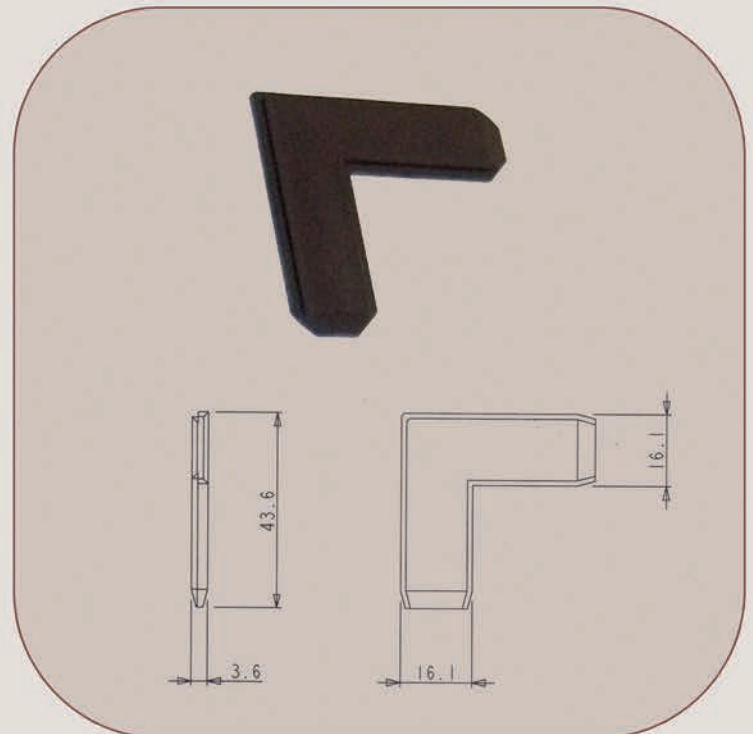

C-AD 155

Sliding Central Seal Pin With Brush

To be fitted on the upper and lower crossbars of the fram with anridust function. Extruded aluminium pain: self - adhesive sponges: stainless steel self threading screws.

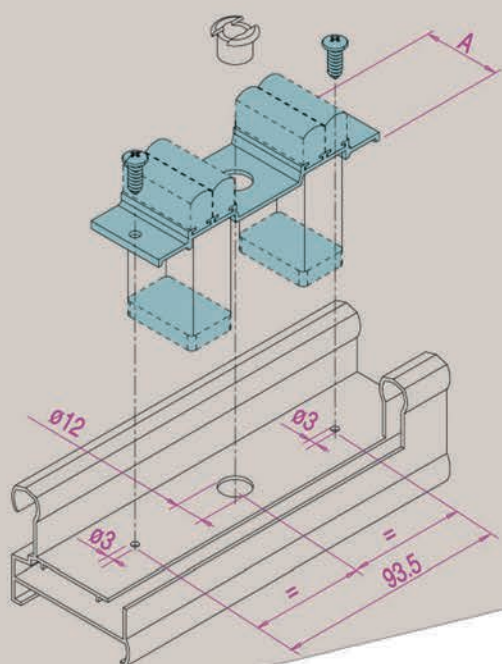

C-AD 156

Sliding door stoper

made of synthetic material for sliding door.

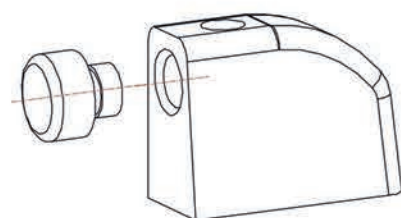
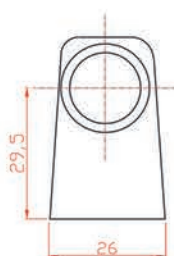
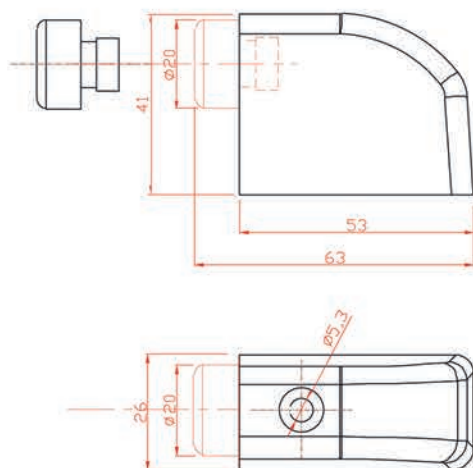

NYLON FLY SCREEN HANDLE

Nylon fly screen handle for lateral installation on aluminium sliding windows and doors

C-AD 157



C-AD 158



C-AD 159

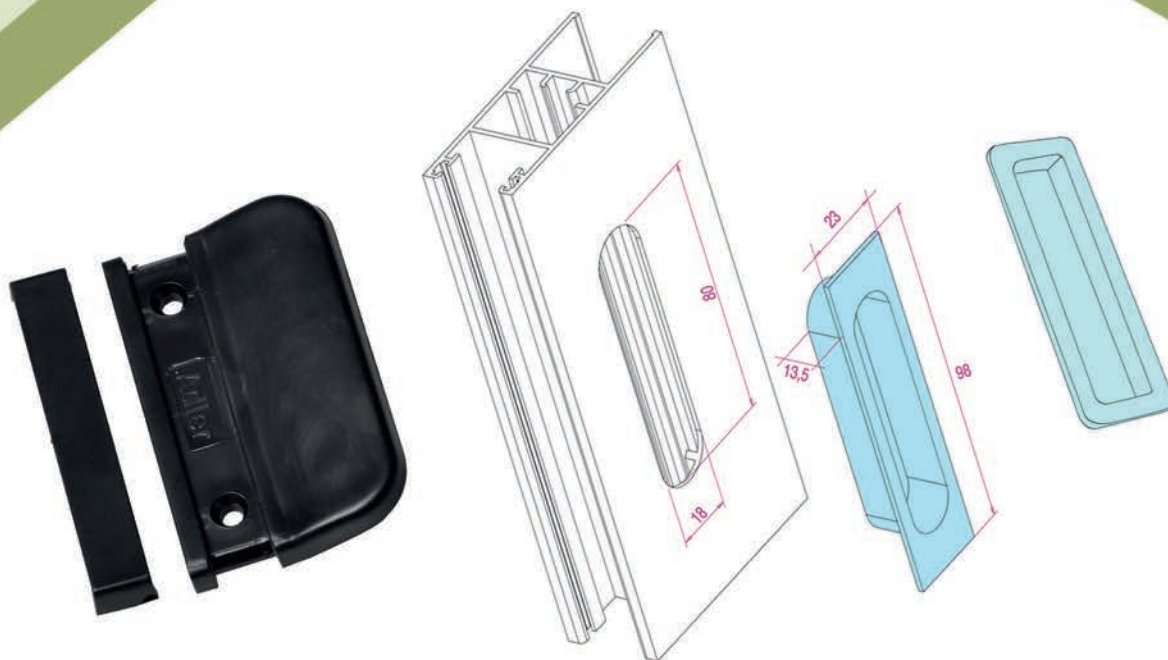

SLIDING DRAINAGE COVER

Nylon element to cover the drainage slot with valve (snap fitting)
with allow water to drain out the value door will stop sand to go inside profile

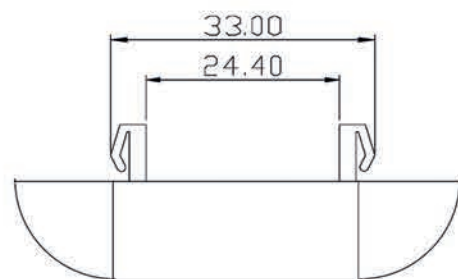
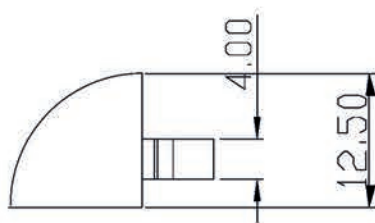
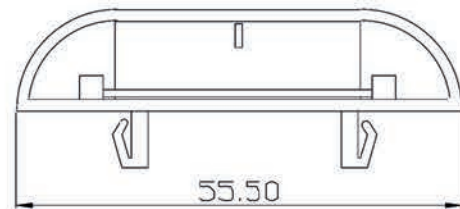
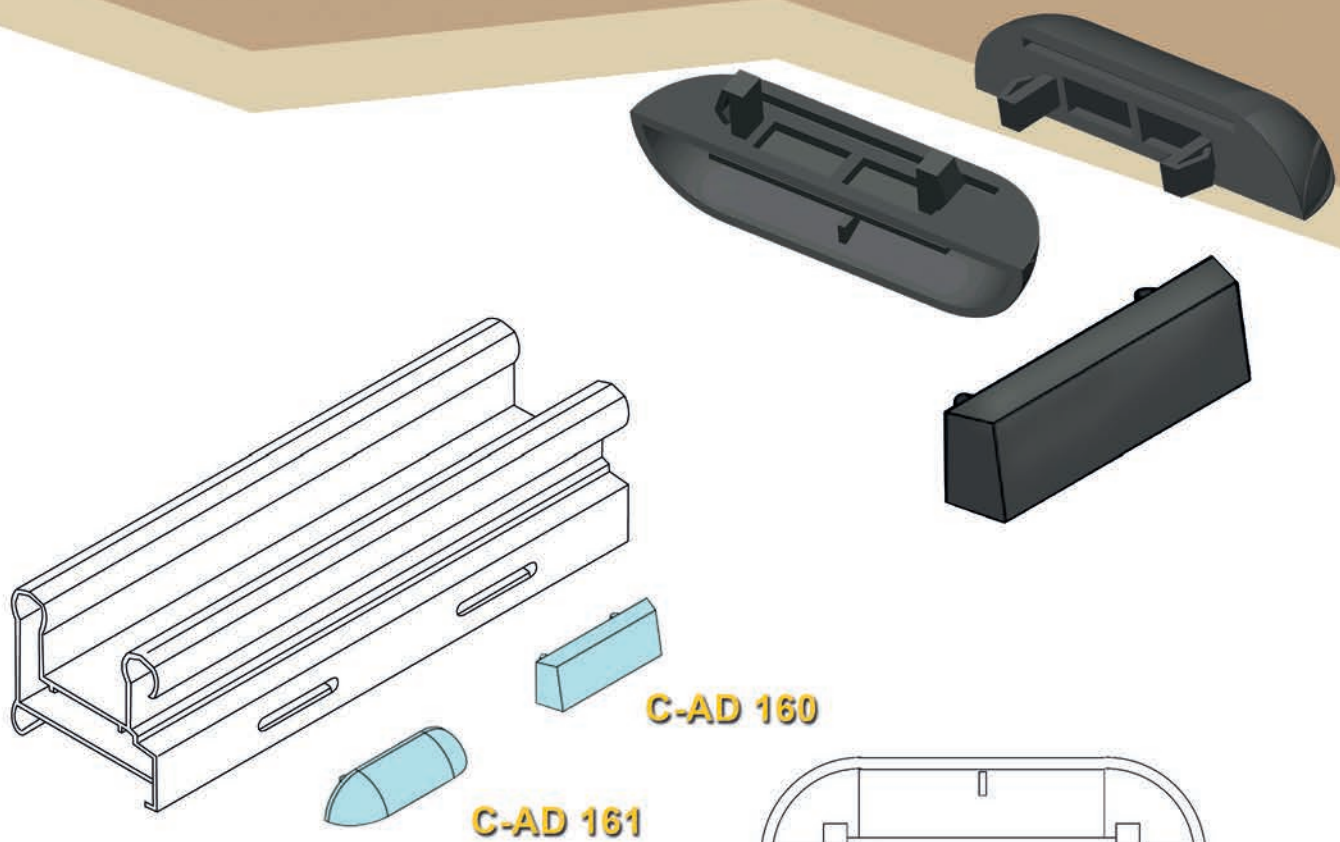

Nylon fly screen corner joint

Using in combination when assembling the aluminum fly screen window and door frame required to align the profile point in the window order when it is assembled it comes with roller and without roller.



C-AD 162

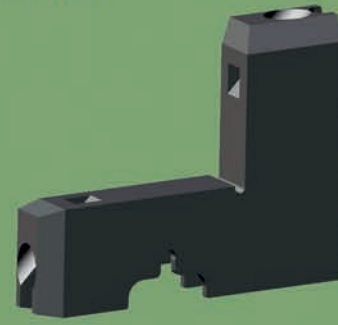

C-AD 163

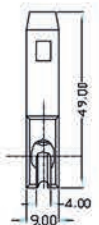
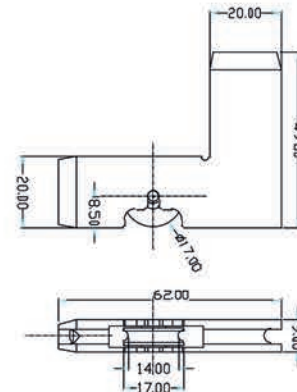
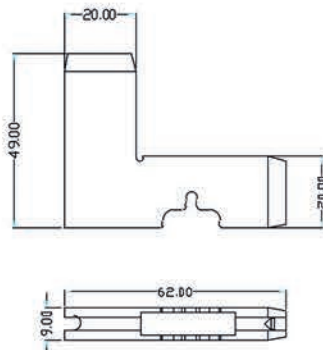
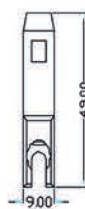
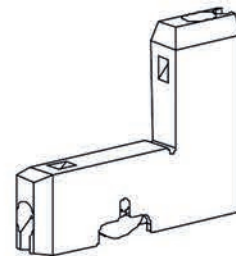
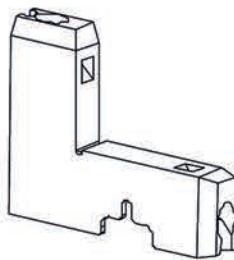

C-AD 164

Sliding Accessories

Nylon guide block for sashes.

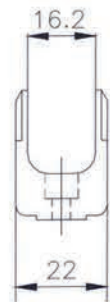
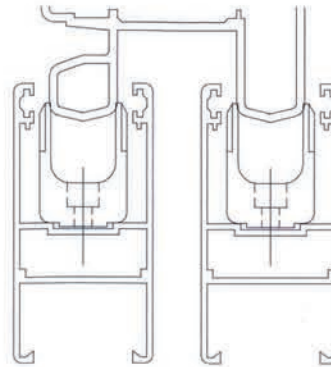

ALIGNMENT CORNER JOINT

Pressure fitting corner joint which aligns the profile fins.

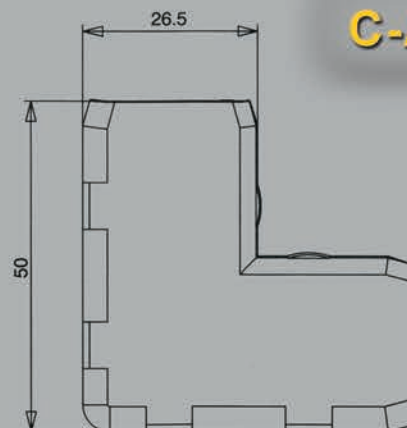
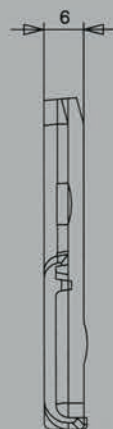
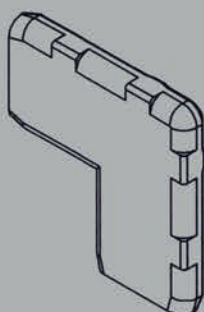

C-AD 165

T - CONNECTOR

T connector support for joining extruded aluminium profile sections.
Quick to install and very secure.

C-AD 166

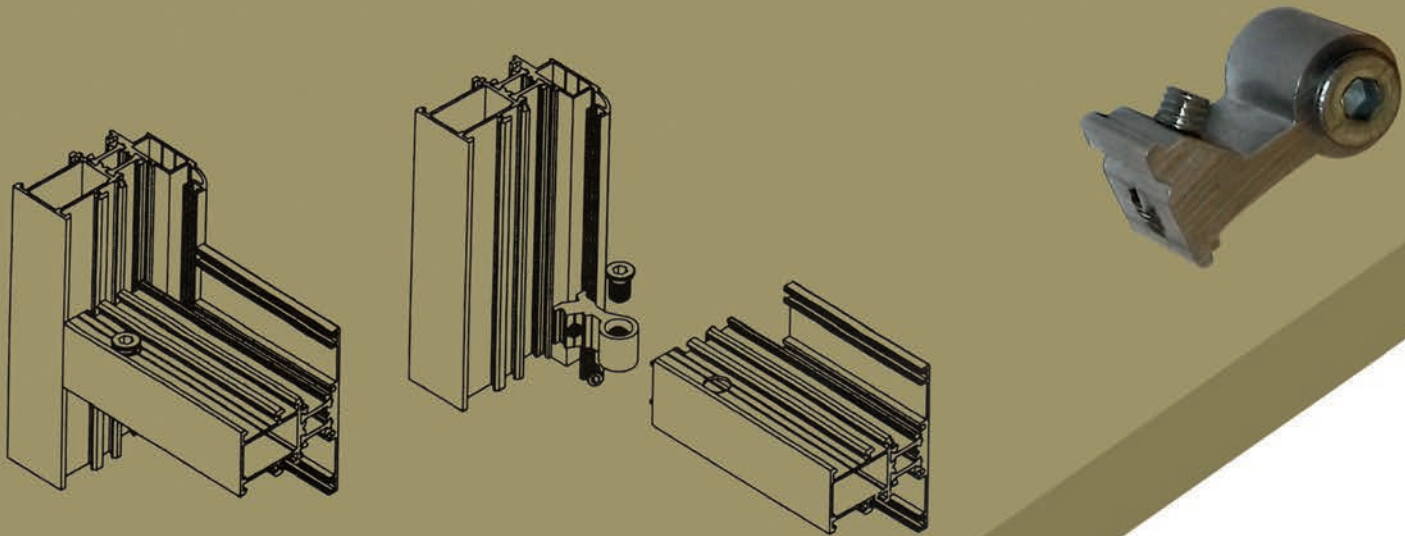

C-AD 167

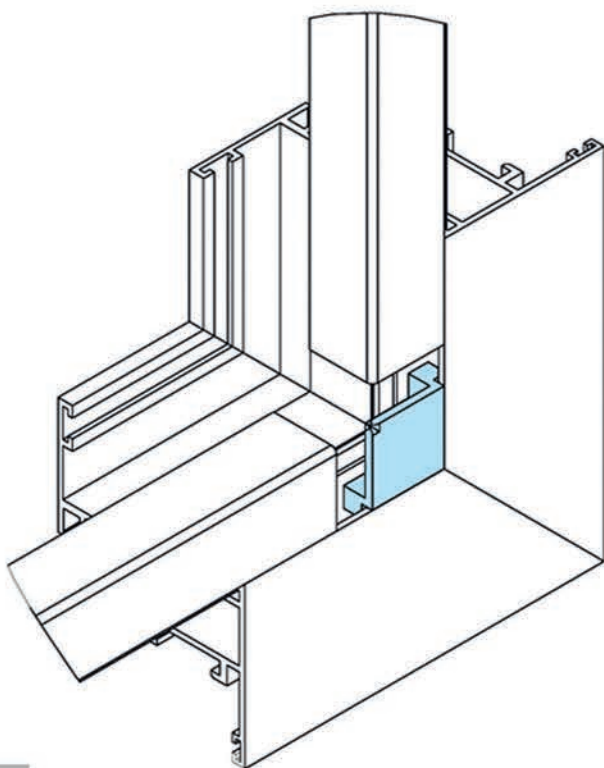

Angel For Rounded Glazing Bead

Accessory which can be fitted on the corner of a shutter to link the spring rounded glazing bead. In die-cast aluminium

Production tape

APPLICATIONS

Temporary protection of surfaces, during medium and severe mechanical transformations of the following materials: Brushed aluminium, ground or deep drawing stainless steel, matt painted coils and PVC profiles/plates.

Not suggested for Copper, brass and copper containing alloys. Not suitable for protection against corrosion, humidity or chemical solvents.

SUITABILITY

suitable for POWDER COATED ALUMINIUM PROFILES ADLER N-2R exhibits the special "EASY-PEEL" characteristics for the rapid removal of the film from high gloss to semi matt surface, such as glossy painted metals.

The removal Forces is inversely proportional to the speed of removal

OUTLINES

Film type

Average Thickness(A.S.T.M)

Colour

UNIT

polyethylene (LDPE) UV Treated

80 MIC

Black / White, Black / Black



Adler

Fan light & Opener



solution for unreachable window

Adler N90

Adler N90 application range

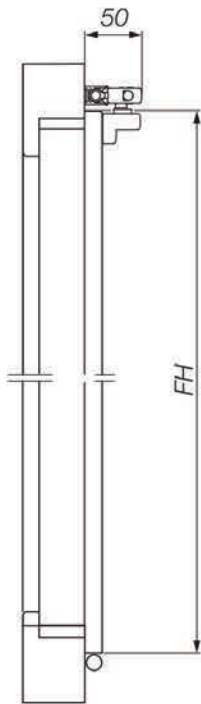
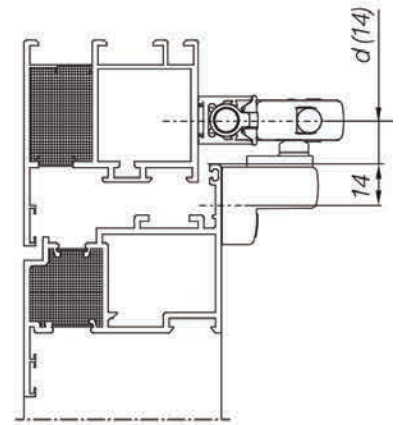
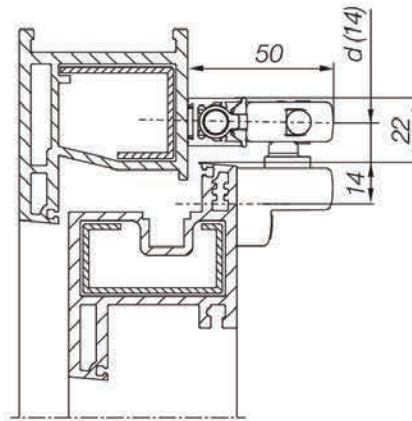
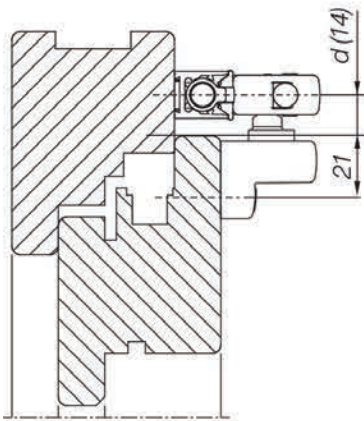

Range of application PRIMAT-FL 190

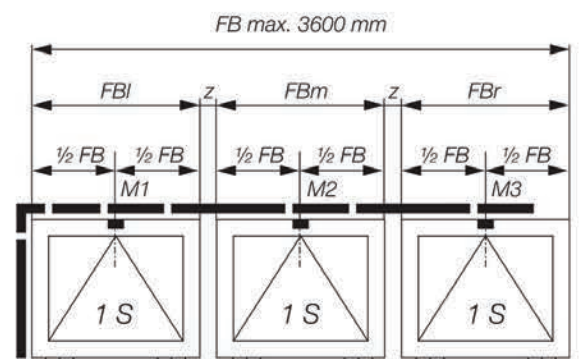
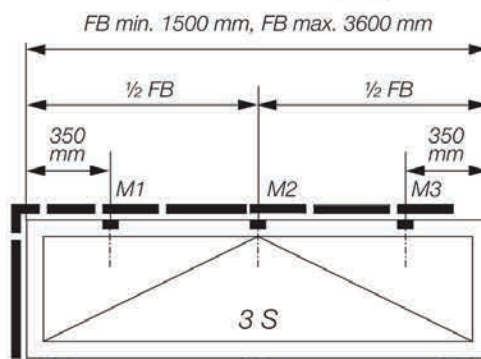
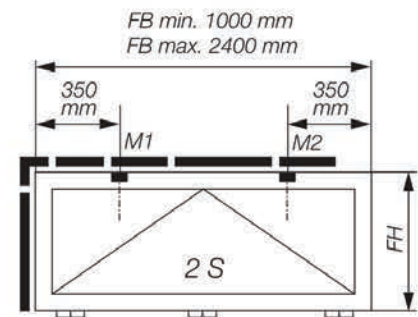
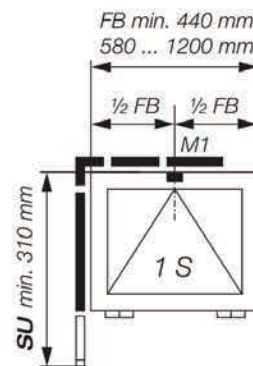
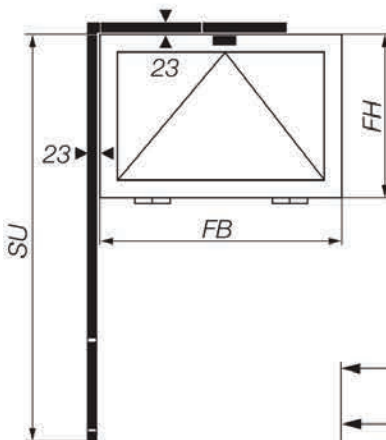
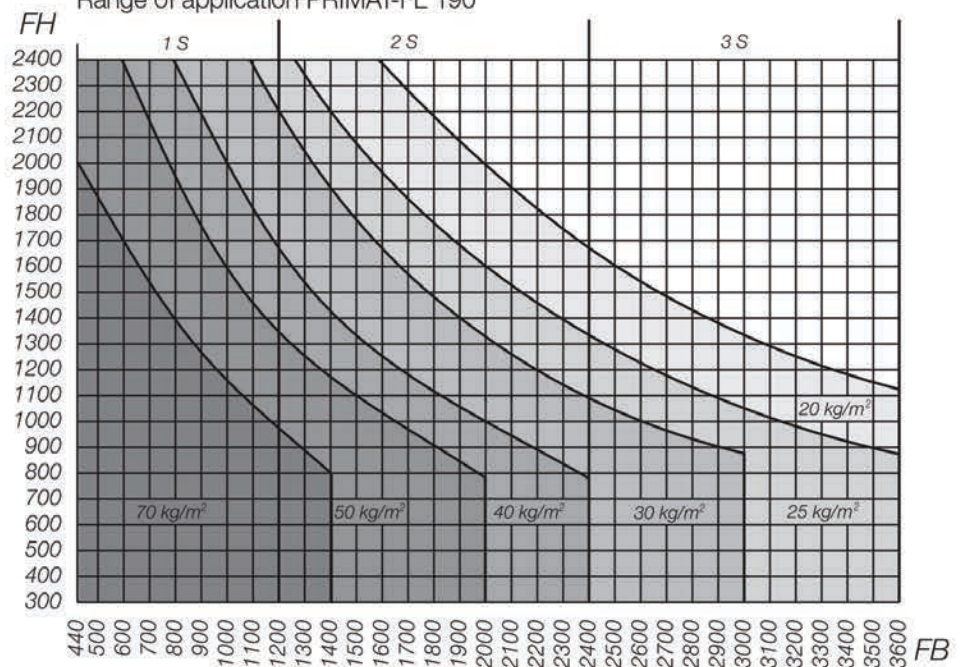

NEW

Door LOCKS

**Mortise lock for
METAL & Wooden DOORS**

Adler
Aluminum & glass hardware

Double, knob and half cylinders
s.s hinges and handles

Lever Handle

Cylinders



NEW

A.D.L.E.R GLASERAI GMBH

E mail : gm@adler-glaserei.com / info.adler-glaserei.com

FIDICINTRABE 3 10965 BERLIN, GERMANY

website : adler-glaserei.com