

Adler

Adler

Friction Hinge

SUS304

SUS304 grade stainless steel can also be rust-proof outdoors



Left & right universal

Can adjusted left & right, allowing for double-opening in both directions



Thick

Thick material

The 3mm thick rod visible to the naked eye



Sturdy rivet

Solid stainless steel rivets, durable and wear-resistant, provide stable and secure connections



A.D.L.E.R Glaserei GmbH

Friction Hinges

Stainless Steel , Heavy Duty , Four to Six Bar Hinges

FEATURES:

- Fit existing window tooling for centre mount installation - No tooling change required.
- Specifically developed track and cap lubrication
- Reinforced collector cap tested to 1970 PSF design
- Pressures without permanent deflection.
- "Gap-Tight" technology assures +/- 0.25mm weatherseal gap(patent pending).

*Dual-sided Containment of vent bar to prevent any sash play, plus large contact and immediate "Pull-in" of sash to prevent weather strip problems



*304SUS Series
Stainless Steel
Rivets

*304SUS Series
Stainless Steel

*Nylon Bearing
Washers at All
Pivot Points

*304SUS Series
Stainless Steel
Track

*Solid Brass Shoe
For Smooth Long-
Lasting Performance

*Stainless Steel Hex Head
Friction Adjuster For Fine
Tension Adjustment

SUS304# FRICTION HINGE



28"



24"

Size:16"-28"

The products are conformed to international technical standard.

(Aluminium alloy Stainless Steel Window Hinges)

The heavy-duty friction stay hinges is applicable for large scale hopper windows, large frame aluminium alloy windows and wooden frame windows. For heavy windows weight above 32kgs. Heavy weight frictional stay hinges shall be used to meet safety demand and easily opening / closing, and provide enough force of friction when open the window.

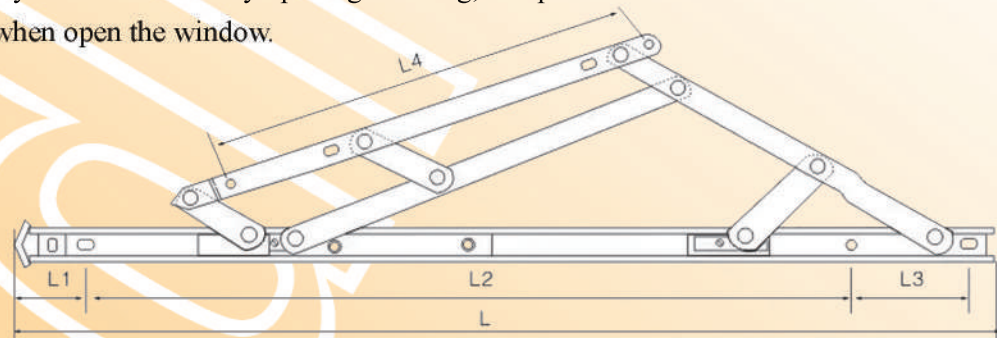

Technical Parameter:

| SIZE | L | L1 | L2 | L3 | L4 | CASEMENT WIDTH (C) | ARM WIDTH (B) | MAX. DOOR/ WINDOW HEIGHT | MAX. DOOR/ WINDOW WIDTH | MAX. DOOR/ WINDOW WEIGHT(Kg) | SUPORTIVE SUSPENSION STRIP THICKNESS | HEIGHT (H) | OPENING ANGLE |
|------|-----|----|-----|----|-----|--------------------|---------------|--------------------------|-------------------------|------------------------------|--------------------------------------|------------|---------------|
| 16" | 400 | 32 | 300 | 70 | 110 | 22.2 | 18 | 1200 | 1000 | 75 | 3.0±0.2 | 17±0.2 | 20°&25° |
| 18" | 450 | 32 | 350 | 70 | 160 | 22.2 | 18 | 1200 | 1200 | 80 | 3.0±0.2 | 17±0.2 | 20°&25° |
| 20" | 500 | 32 | 400 | 70 | 210 | 22.2 | 18 | 1400 | 1200 | 90 | 3.0±0.2 | 17±0.2 | 20°&25° |
| 22" | 550 | 32 | 450 | 70 | 260 | 22.2 | 18 | 1500 | 1200 | 100 | 3.0±0.2 | 17±0.2 | 20°&25° |
| 24" | 600 | 32 | 500 | 70 | 310 | 22.2 | 18 | 1600 | 1200 | 105 | 3.0±0.2 | 17±0.2 | 20°&25° |
| 26" | 650 | 32 | 550 | 70 | 360 | 22.2 | 18 | 1800 | 1400 | 135 | 3.0±0.2 | 17±0.2 | 20°&25° |
| 28" | 700 | 32 | 600 | 70 | 410 | 22.2 | 18 | 2000 | 1500 | 150 | 3.0±0.2 | 17±0.2 | 20°&25° |

SUS304# FRICTION HINGE

SIZE SHEET

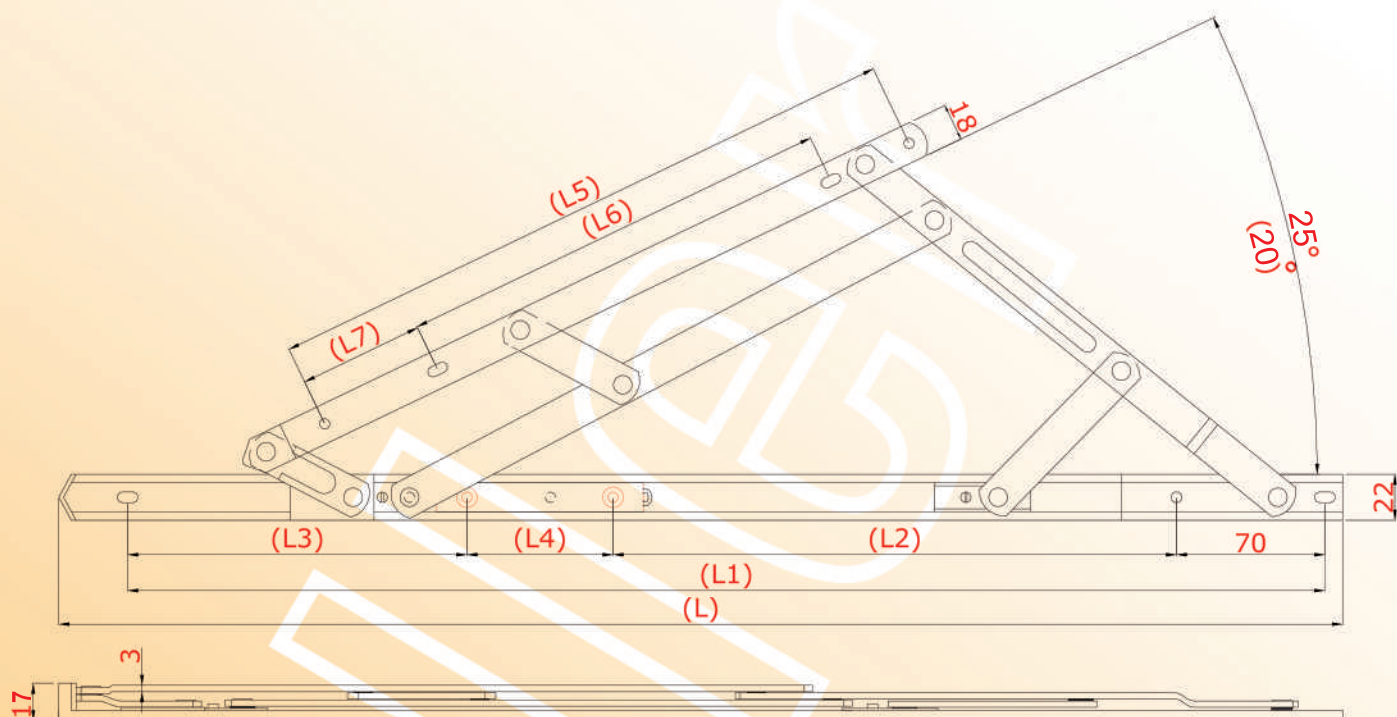

A.D.L.E.R Glaserei GmbH

304# S. STEEL FRICTION HINGE

| SPEC. | (L) | (L1) | (L2) | (L3) | (L4) | (L5) | (L6) | (L7) |
|-------|-----|------|------|------|------|------|------|------|
| 16" | 413 | 373 | 109 | 140 | 70 | 200 | 100 | 60 |
| 18" | 464 | 424 | 139 | 150 | 70 | 228 | 126 | 60 |
| 20" | 508 | 0 | 0 | 0 | 70 | 0 | 0 | 60 |
| 22" | 562 | 523 | 219 | 159 | 70 | 287 | 184 | 60 |
| 24" | 615 | 573 | 270 | 162 | 70 | 310 | 209 | 60 |
| 26" | 660 | 0 | 0 | 0 | 70 | 0 | 0 | 60 |
| 28" | 718 | 678 | 345 | 185 | 70 | 360 | 258 | 60 |

TOP - HUNG WIDOW SUS304 FRICTION STAY

Manufactured From High Grade Stainless-Steel.

- Engineering /Plastic Slider For Strength.
- Durability and Smooth Operation.
- Be Suitable For Large Top-Hung Application. It Provides Adequate Friction at All Opening Angles.
- Double Slider With Additional Linkage Bar For Support a Top - Hung Window Vent Up to Maximum 150Kgs.

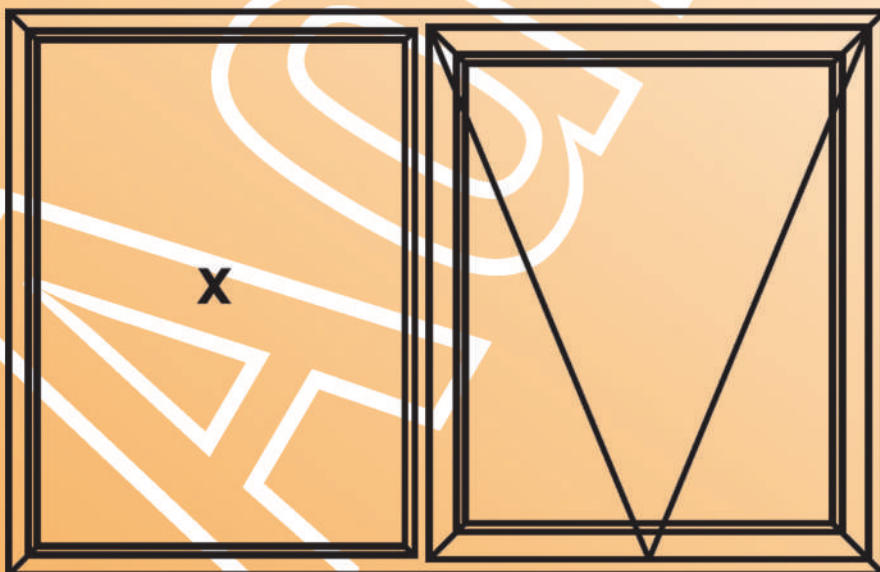

TOP HUNG WINDOW

- Arm Thickness 3.0mm.
- Arm Width 18mm.
- Base Width 22mm.

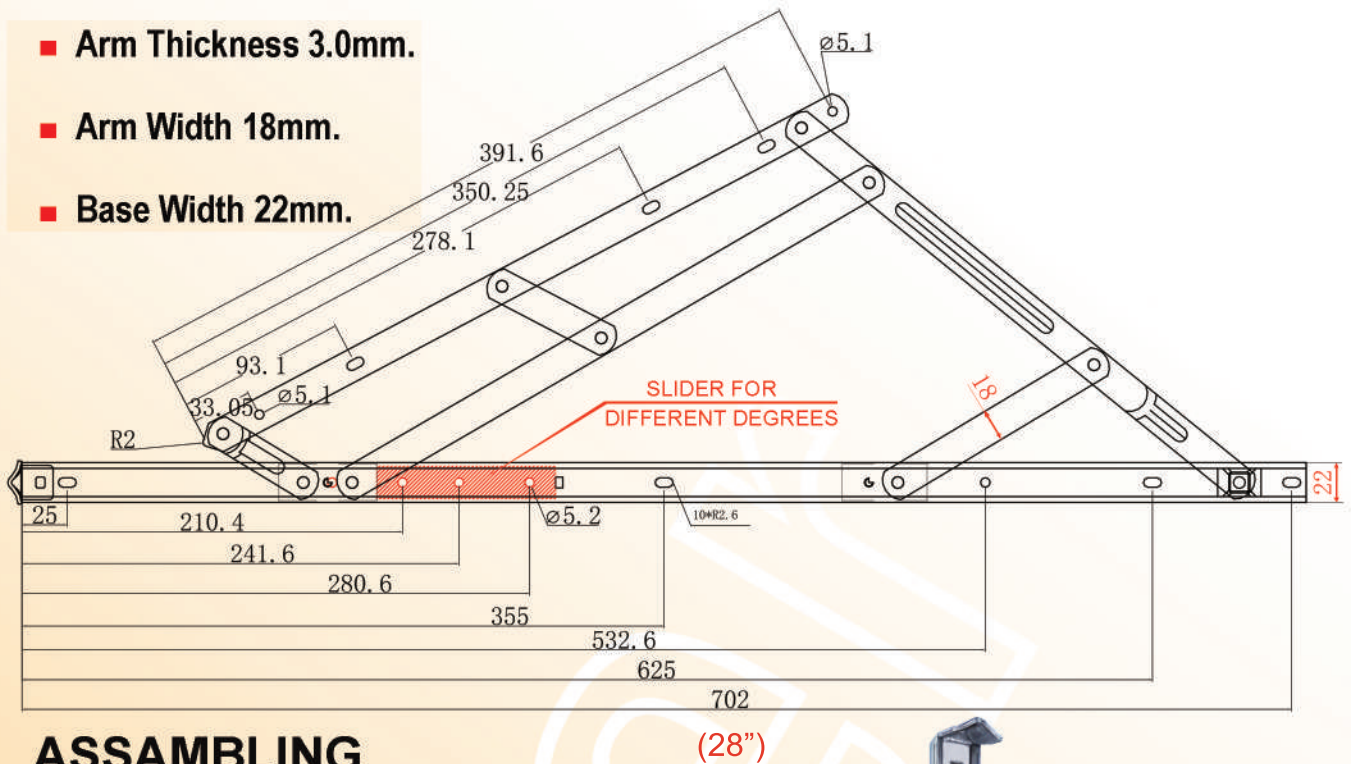

ASSAMBLING

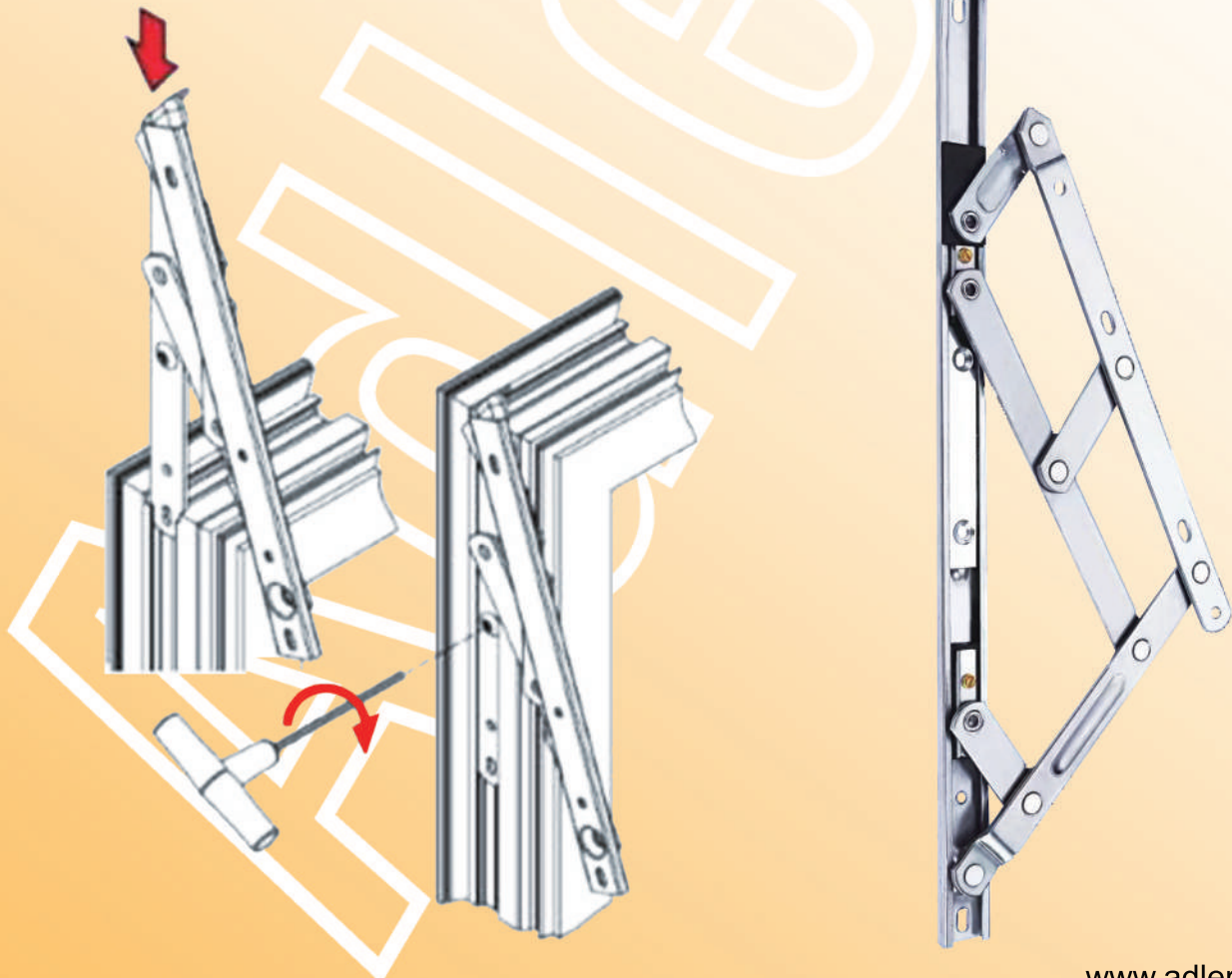

TOP HUNG WINDOW ASSAMBLING STEPS



01 When the rivet at the top of the hinge exposes about half of the window sash, mark the corresponding hole spacing.



02 Drilling holes in marked position and fixing with screws. The same is true for the upper and lower sash parts.



03 Install the hinge near the upper part of the window, and tighten the screw after testing the switch for normal operation



04 Installation completed, outdoor effect display

Adler

SUS304# FRICTION HINGE

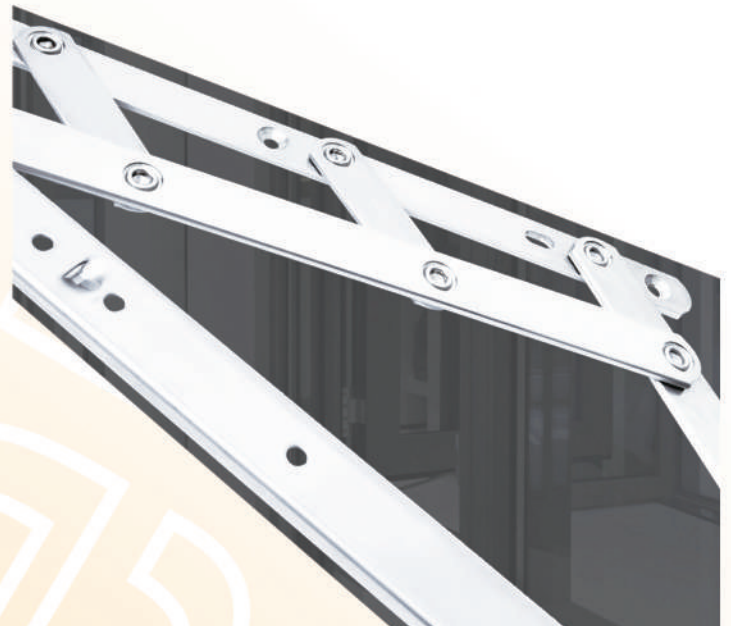

A.D.L.E.R Glaserei GmbH

After 30,000 times of repeated opening and closing tests, it can still be used normally.

